



# Borbolla

METROLOGY

Ventas@borbollametrology.com  
www.borbollametrology.com  
Tel 844 412 88 68

# RAYCO®

FIXTURE

## Catalog 17.1

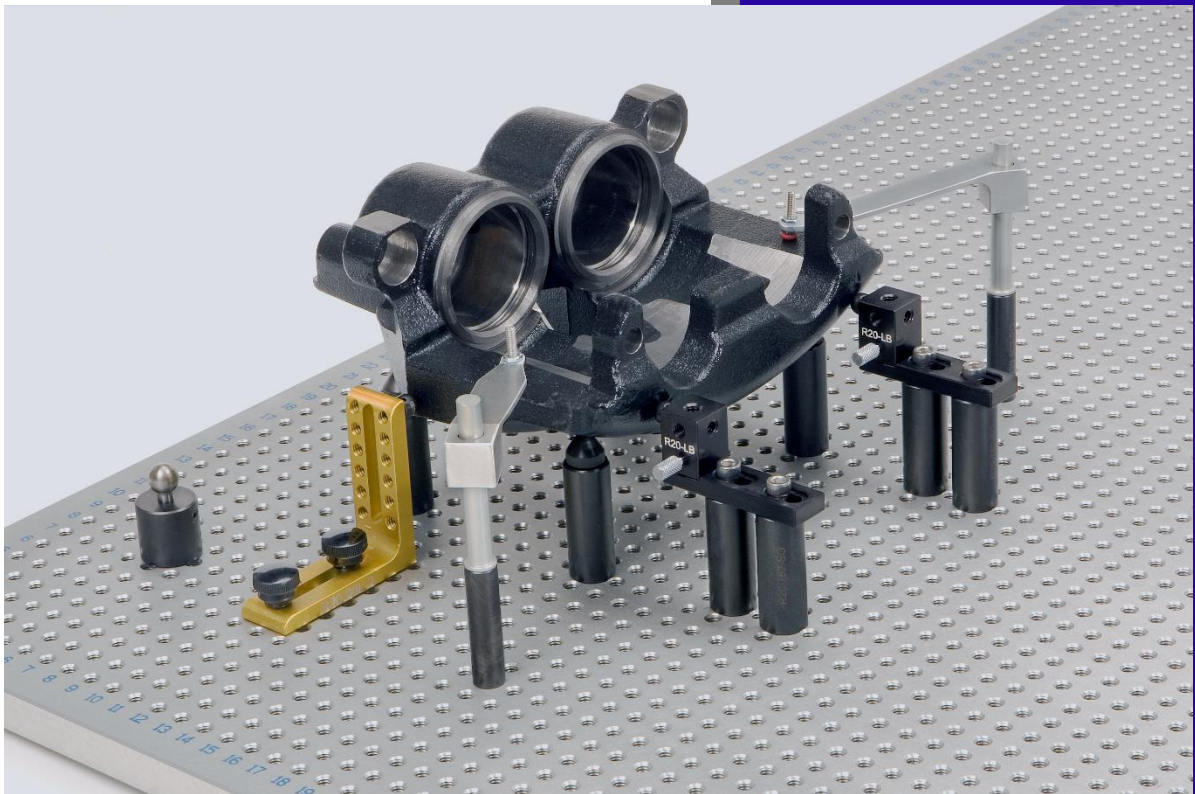

5520 Bridgewood Drive  
Sterling Heights, MI 48310

Office: (586)795-2884  
Fax: (586)795-3260  
Email: sales@raycofixture.com

[www.raycofixture.com](http://www.raycofixture.com)



# TABLE OF CONTENTS

## FIXTURE PLATES

---

Aluminum	1
Steel	2
Round	3
Vision Plates & RVFL's	4

## CUSTOM FIXTURES

---

5

## METROLOGY TABLES

---

6

## COMPONENT KITS

---

Standard Clamping Kits	7-10
Magnetic Clamping Kits	11-14
Vacuum Kits	15-17
Vision Kits	18-20

## ACCESSORIES & COMPONENTS

---

21-38

## ALUMINUM EXTRUSION KITS & COMPONENTS

---

AX Kits	39
AX Components	40-41



# Aluminum Fixture Plates

Our Standard Cast Aluminum Plates are protected with a clear hard lube anodize with engraved numbers in the X-axis and letters in the Y-axis.

- Customize your plate size, hole spacing and thread type.
- Mounting Holes and fasteners are included at no added cost.

## 1/4-20 Thread

Part Number	Length	Width	Thickness	Hole Spacing
R20-66375-50	6"	6"	.375"	1/2"
R20-121250-50	12"	12"	1/2"	1/2"
R20-151550-50	15"	15"	1/2"	1/2"
R20-181850-50	18"	18"	1/2"	1/2"
R20-242450-50	24"	24"	1/2"	1/2"
R20-242475-50	24"	24"	3/4"	1/2"
R20-284075-50	28"	40"	3/4"	1/2"
R20-303075-50	30"	30"	3/4"	1/2"

## M8 Thread

Part Number	Length	Width	Thickness	Hole Spacing
R8-30030013-15	300 mm	300 mm	13 mm	15 mm
R8-45045013-15	450 mm	450 mm	13 mm	15 mm
R8-60060013-15	600 mm	600 mm	13 mm	15 mm
R8-60060019-15	600 mm	600 mm	19 mm	15 mm
R8-75075019-15	750 mm	750 mm	19 mm	15 mm

## M6 Thread

Part Number	Length	Width	Thickness	Hole Spacing
R6-30030013-15	300 mm	300 mm	13 mm	15 mm
R6-45045013-15	450 mm	450 mm	13 mm	15 mm
R6-60060013-15	600 mm	600 mm	13 mm	15 mm
R6-60060019-15	600 mm	600 mm	19 mm	15 mm

## M4 Thread

Part Number	Length	Width	Thickness	Hole Spacing
R4-15015010-10	150 mm	150 mm	10 mm	10 mm

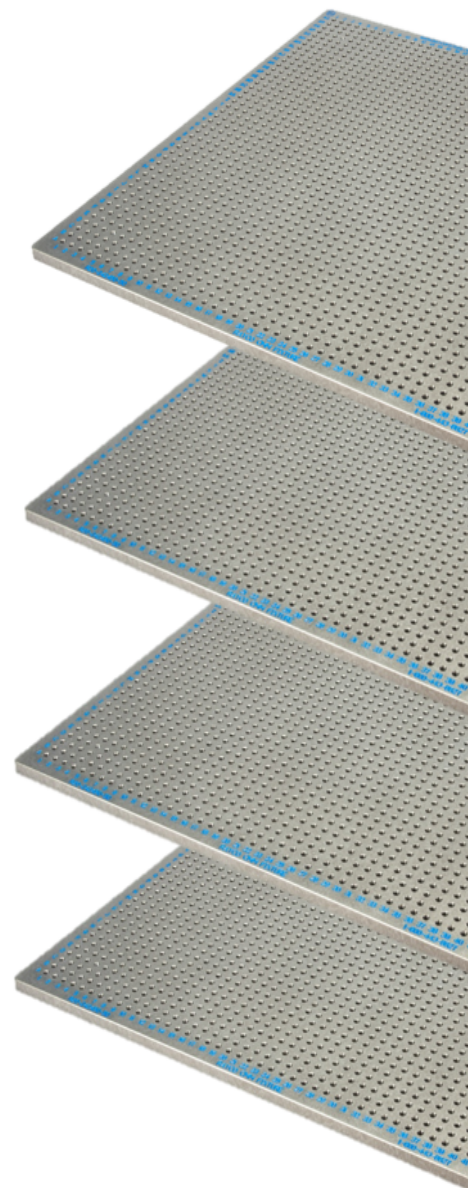

# Steel Fixture Plates

Our Steel Fixture Plates are hardened to 28/32 RC for durability and have a Black Oxide Coating with engraved numbers in the X-axis and letters in the Y-axis.

- Customize your plate size, hole spacing and thread type.
- Mounting Holes and Fasteners are included at no added cost.

## 1/4-20 Thread

Part Number	Length	Width	Thickness	Hole Spacing
R20-181875-50-S	18"	18"	3/4"	1/2"
R20-242475-50-S	24"	24"	3/4"	1/2"
R20-30301-50-S	30"	30"	1"	1/2"

## M8 Thread

Part Number	Length	Width	Thickness	Hole Spacing
R8-45045019-15-S	450 mm	450 mm	19 mm	15 mm
R8-60060019-15-S	600 mm	600 mm	19 mm	15 mm
R8-75075025-15-S	750 mm	750 mm	25 mm	15 mm

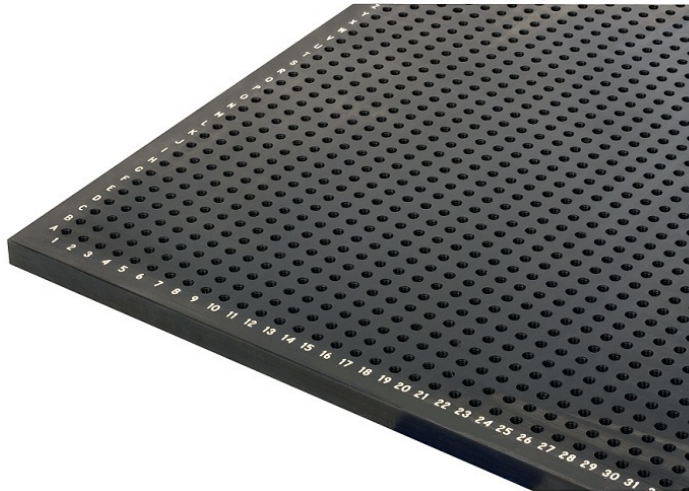

# Round Fixture Plates

Our Round Fixture plates are protected with a clear hard lube anodize with engraved numbers in the X-axis and Letters in the Y-axis through the diameter of the plate.

- Customize your plate size, hole spacing and thread type.
- Mounting Holes and Fasteners are included at no added cost.
- Rotational Base Upon Request.

## 1/4-20 Thread

Park Number	Diameter	Thickness	Hole Spacing
R20-650-50-RR	6"	1/2"	1/2"
R20-850-50-RR	8"	1/2"	1/2"
R20-1850-50-RR	18"	1/2"	1/2"
R20-2475-50-RR	24"	3/4"	1/2"

## M8 Thread

Park Number	Diameter	Thickness	Hole Spacing
R8-30013-15-RR	300 mm	13 mm	15 mm
R8-45013-15-RR	450 mm	13 mm	15 mm
R8-60019-15-RR	600 mm	19 mm	15 mm
R8-90019-15-RR	900 mm	19 mm	15 mm

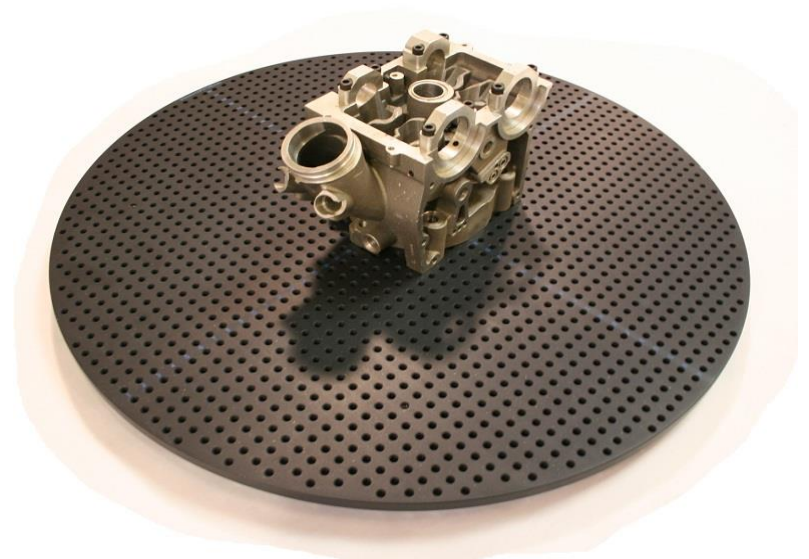
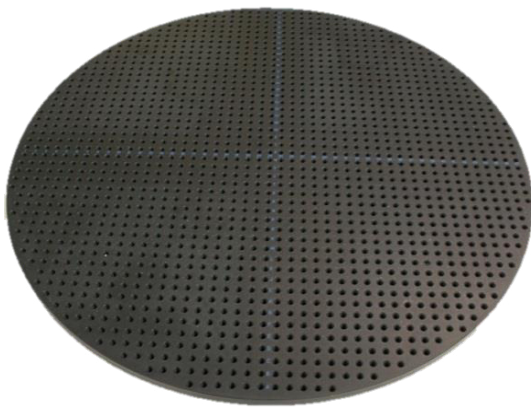

# Vision Plates & RVFL's

Rayco Acrylic Plates are made from optical grade acrylic with engraved numbers in the X-Axis and letters in the Y-Axis. Steel edge inserts are added to each plate to work with our magnetic RVFL system. The RVFL mounts to the outer stage of your vision machine and allows for a quick plate change.

- Customize your plate size, hole spacing and thread type.
- Viewing Window to Customer specifications
- Full Frame Fixtures Available Upon Request

## 1/4-20 Thread

Part Number	Length	Width	Thickness	Hole Spacing
RA20-060650-50	6"	6"	1/2"	1/2"
RA20-121275-50	12"	12"	3/4"	1/2"
RA20-140975-50	14"	9"	3/4"	1/2"

## M4 Thread

Part Number	Length	Width	Thickness	Hole Spacing
RA4-15015013-10	150 mm	150 mm	13 mm	10 mm
RA4-30030019-15	300 mm	300 mm	19 mm	15 mm
RA4-40040019-15	400 mm	400 mm	19 mm	15 mm

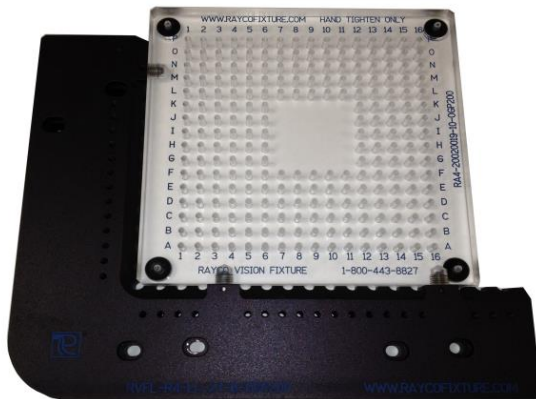

## Rayco Vision Fixture Locator (RVFL)

Part Number	Plate Match
RVFLII-1	< 160 mm / 6.25"
RVFLII-2	161 mm - 300 mm / 12"
RVFLII-3	301 mm - 450 mm / 18"
RVFLII-4	451 mm - 600 mm / 23"
RVFLII-5	601 mm / 24"+

# Custom Fixtures

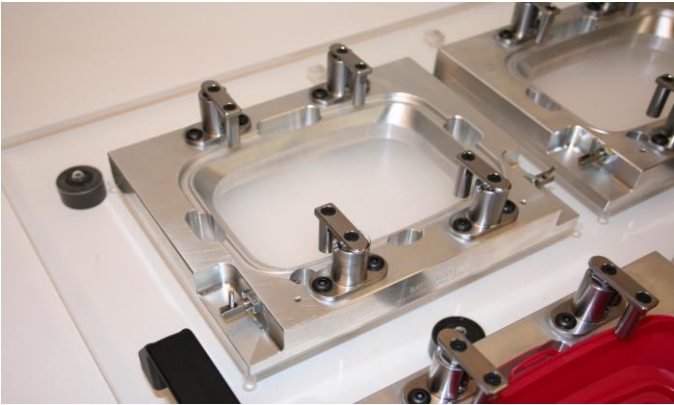

Rayco Fixture also excels in making custom fixtures to fit any part. Whether dedicated or adjustable, we can make a fixture to fit your needs. We have made fixtures for many applications, such as:

- CMM
- Vision System
- Quick Check
- Assembly
- Welding

Get your personalized quote today!

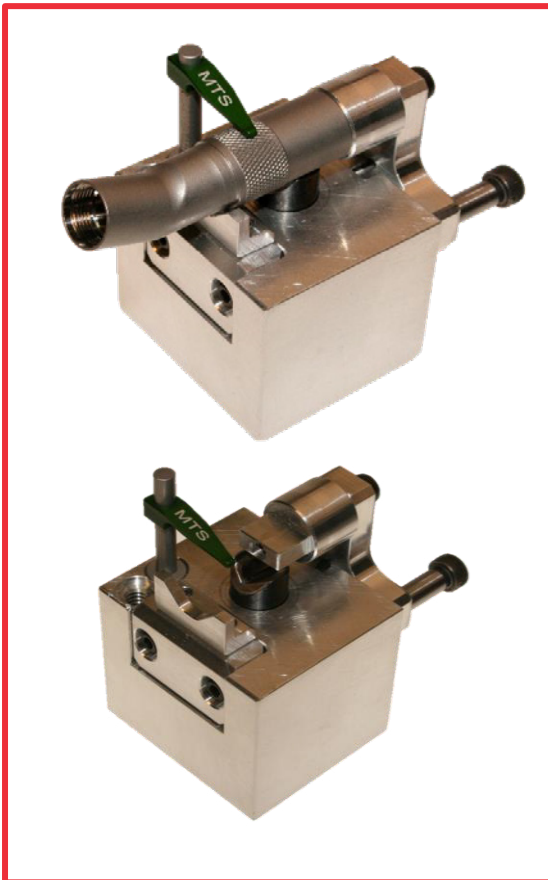

Multiple Setups, ONE Fixture!

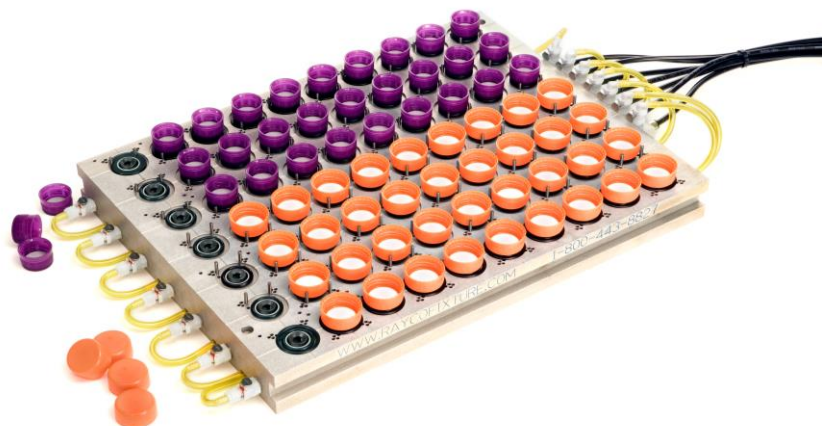

# Metrology Tables

"Perfect for your Portable Measurement Device"

Rayco's Metrology Table frames are constructed from extruded aluminum and are matched with a Rayco Fixture Plate of your choice (plate sold separately). Includes Premium "non-grooved" material on the outside surface of frame. Each table is made to order.

## Portable Metrology Tables

Part Number	Length	Width	Height
R-2436-MT	24"	36"	36"
R-3648-MT	36"	48"	36"
R-4260-MT	42"	60"	36"
R-4872-MT	48"	72"	36"
R-4878-MT	48"	78"	36"
R-6096-MT	60"	96"	36"

**Features:**

- (2) Heavy Duty Fixed Wheels
- (2) Heavy Duty Swivel Wheels
- (4) Foot Operated Floor Locks
- (1) 1/4" Black ABS Bottom Shelf

## Stationary Metrology Tables

Part Number	Length	Width	Height
R-2436-SMT	24"	36"	36"
R-3648-SMT	36"	48"	36"
R-4872-SMT	42"	60"	36"
R-4878-SMT	48"	72"	36"
R-4260-SMT	48"	78"	36"
R-6096-SMT	60"	96"	36"

**Features:**

- (1) 1/4" Black ABS Bottom Shelf
- NO Wheels
- NO Floor Locks



Portable Aluminum Table



Floor-Locks

# Clamping Kits: 1/4-20 Thread



R20-CK-C

Part Numbers	Description	R20-CK-A	R20-CK-B	R20-CK-C
R20-37550-SO	3/8" Dia. x 1/2" Standoff		3	6
R20-5050-SO	1/2" Dia. X 1/2" Standoff			4
R20-5075-SO	1/2" Dia. X 3/4" Standoff	3	6	8
R20-501-SO	1/2" Dia. X 1" Standoff	3	6	8
R20-502-SO	1/2" Dia. X 2" Standoff	3	6	8
R20-7550-SO	3/4" Dia. X 1/2" Standoff		3	4
R20-7575-SO	3/4" Dia. X 3/4" Standoff	3	6	8
R20-751-SO	3/4" Dia. X 1" Standoff	3	6	8
R20-752-SO	3/4" Dia. X 2" Standoff	3	6	8
R20-754-SO	3/4" Dia. X 4" Standoff		4	6
R20-175-SO	1" Dia. X 3/4" Standoff	3	6	8
R20-11-SO	1" Dia. X 1" Standoff	3	6	8
R20-12-SO	1" Dia. X 2" Standoff	3	6	8
R20-14-SO	1" Dia. X 4" Standoff		4	6
R20-501-PSO:	1/2" Dia. X 1" Pin Standoff	2	4	4
R20-7575-PSO	3/4" Dia. X 3/4" Pin Standoff			2
R20-ST5-15	Small Tension Spring - 1.5" Post	2	6	6
R20-LTS-3	Large Tension Spring - 3" Post	4	12	12
R20-XLTS	X-Large Tension Spring - 3" Post			3
R20-XLTSP	X-Large Tension Spring with Plunger			3
R20-1-TSB	1" Dia. Tension Spring Bracket			1
R20-NC	Nylon Cone	3	4	6
R20-SRP	Steel Resting Pin		4	6
R20-APJ	Adjustable Pivot Joint			1
R20-50-JS	1/2" Dia. Jackstand	1	2	3
R20-1-JS	1" Dia. Jackstand		2	3
R20-MSLD	Mini Slide Base	1	2	3
R20-SLD	Slide Base	1	2	4
R20-LB	Locating Block with Base		2	2
R20-112-MT4	1" Sq. x 12" Mini Tower			1
R20-SCT	1/4-20 Small Component Tray	1		
R-CASE-B	Case for B Kit (1 Layer)		1	
R-CASE-C	Case for C Kit (2 Layers)			1
<b>Total Components</b>		<b>42</b>	<b>109</b>	<b>159</b>

# Clamping Kits: M8 Thread



Part Numbers	Description	R8-CK-A	R8-CK-B	R8-CK-C
R8-1315-SO	13mm Dia. X 15mm Standoff		3	4
R8-1320-SO	13mm Dia. X 20mm Standoff	3	6	8
R8-1325-SO	13mm Dia. X 25mm Standoff	3	6	8
R8-1350-SO	13mm Dia. X 50mm Standoff	3	6	8
R8-1915-SO	19mm Dia. X 15mm Standoff		3	4
R8-1920-SO	19mm Dia. X 20mm Standoff	3	6	8
R8-1925-SO	19 mm Dia. X 25 mm Standoff	3	6	8
R8-1950-SO	19mm Dia. X 50mm Standoff	3	6	8
R8-19100-SO	19mm Dia. X 100mm Standoff		4	6
R8-2520-SO	25mm Dia. X 20mm Standoff	3	6	8
R8-2525-SO	25mm Dia. X 25mm Standoff	3	6	8
R8-2550-SO	25mm Dia. X 50mm Standoff	3	6	8
R8-25100-SO	25mm Dia. X 100mm Standoff		4	6
R8-1325-PSO	13mm Dia. X 25mm Pin Standoff	2	4	6
R8-ST5-38	Small Tension Spring - 38mm Post	2	6	6
R8-LTS-75	Large Tension Spring - 75mm Post	4	12	12
R8-XLTS	X-Large Tension Spring - 75mm Post			3
R8- XLTSP	X-Large Tension Spring with Plunger			3
R8-25-TSB	25mm Dia. Tension Spring Bracket			1
R8-NC	Nylon Cone	3	4	4
R8-SC	Steel Cone		4	4
R8-PJ	Pivot Joint			1
R8-19-JS	19mm Dia. Small Jackstand	1	2	4
R8-25-JS	25mm Dia. Large Jackstand		2	3
R8-SLD	Slide Base	1	3	6
R8-LB	Locating Block with Base		2	2
R8-25300-MT4	25mm Sq. X 300mm Mini Tower			1
R8-SCT	M8 Small Component Tray	1		
R-CASE-B	Case for B Kit (1 Layer)		1	
R-CASE-C	Case for C Kit (2 Layers)			1
<b>Total Components</b>		<b>41</b>	<b>108</b>	<b>149</b>

# Clamping Kits: M6 Thread



R6-CK-C

Part Numbers	Description	R6-CK-A	R6-CK-B	R6-CK-C
R6-910-SO	9mm Dia. x 10mm Standoff		3	6
R6-1310-SO	13mm Dia. x 10mm Standoff			4
R6-1320-SO	13mm Dia. X 20mm Standoff	3	6	8
R6-1325-SO	13mm Dia. X 25mm Standoff	3	6	8
R6-1350-SO:	13mm Dia. X 50mm Standoff	3	6	8
R6-1910-SO	19mm Dia. X 10mm Standoff		3	4
R6-1920-SO	19mm Dia. X 20mm Standoff	3	6	8
R6-1925-SO	19 mm Dia. X 25 mm Standoff	3	6	8
R6-1950-SO	19mm Dia. X 50mm Standoff	3	6	8
R6-19100-SO	19mm Dia. X 100mm Standoff		4	6
R6-2520-SO	25mm Dia. X 20mm Standoff	3	6	8
R6-2525-SO	25mm Dia. X 25mm Standoff	3	6	8
R6-2550-SO	25mm Dia. X 50mm Standoff	3	6	8
R6-25100-SO	25mm Dia. X 100mm Standoff		4	6
R6-1325-PSO	13mm Dia. X 25mm Pin Standoff	2	4	4
R6-1920-PSO	19mm Dia. X 20mm Pin Standoff			2
R6-ST5-38	Small Tension Spring - 38mm Post	2	6	6
R6-LTS-75	Large Tension Spring - 75mm Post	4	12	12
R6-XLTS	X-Large Tension Spring			3
R6-XLTSP	X-Large Tension Spring with Plunger			3
R6-25-TSB	25mm Dia. Tension Spring Bracket			1
R6-NC	Nylon Cone	3	4	6
R6-SRP	Steel Resting Pin		4	6
R6-APJ	Adjustable Pivot Joint			1
R6-13-JS	13mm Dia. Jackstand	1	2	3
R6-25-JS	25mm Dia. Jackstand		2	3
R6-MSLD	Mini Slide base	1	2	3
R6-SLD	Slide Base	1	2	4
R6-LB	Locating Block with Base		2	2
R6-25300-MT4	25mm sq. x 300mm Mini Tower			1
R6-SCT	M6 Small Component Tray	1		
R-CASE-B	Case for B Kit (1 Layer)		1	
R-CASE-C	Case for C Kit (2 Layers)			1
<b>Total Components</b>		<b>42</b>	<b>109</b>	<b>159</b>

# Clamping Kits: M4 Thread



Part Numbers	Description	R4-CK-A	R4-CK-B
R4-65-SO	6mm Dia. X 5mm Standoff		3
R4-610-SO	6mm Dia. X 10mm Standoff	2	6
R4-625-SO	6mm Dia. X 25mm Standoff	4	6
R4-95-SO	9mm Dia. X 5mm Standoff	3	3
R4-910-SO	9mm Dia. X 10mm Standoff	3	6
R4-920-SO	9mm Dia. X 20mm Standoff		6
R4-925-SO	9mm Dia. X 25mm Standoff	4	6
R4-1210-SO	12mm Dia. X 10mm Standoff	3	6
R4-1225-SO	12mm Dia. X 25mm Standoff	4	6
R4-610-PSO	6mm Dia. X 10mm Pin Standoff	3	4
R4-910-PSO	9mm Dia. X 10mm Pin Standoff	2	4
R4-1210-PSO	12mm Dia. X 10mm Pin Standoff		4
R4-MTS-25	Mini Tension Spring - 25mm Post		4
R4-WTS-32-50	32mm Wire Tension Spring - 50mm Post	3	4
R4-WTS-50-50	50mm Wire Tension Spring - 50mm Post	2	4
R4-ST5-50	Small Tension Spring - 50mm Post	2	4
R4-MSLD	Mini Slide Base	1	2
R4-MJS	Mini JackStand	1	2
R4-ARP	Aluminum Resting Pin	5	4
R4-LB	Locating Block with Base		1
R4-MCV	Mini Corner Viewer	1	1
R4-PC	Pusher Clamp		1
R4-MCT	M4 Mini Component Tray		1
AX-BOX	Organizer Box	1	
<b>Total Components</b>		<b>44</b>	<b>88</b>

# Magnetic Clamping Kits: ¼-20 Thread



Part Numbers	Description	R20-MCK-A	R20-MCK-B	R20-MCK-C
R20-50-M	1/2" Dia. Magnet	3	4	6
R20-75-M	3/4" Dia. Magnet	3	4	6
R20-1-M	1" Dia. Magnet	3	4	6
R20-50-PM	1/2" Dia. Pin Magnet		2	2
R20-75-PM	3/4" Dia. Pin Magnet			2
R20-37550-SO	3/8" Dia. x 1/2" Standoff		3	4
R20-5050-SO	1/2" Dia. X 1/2" Standoff			4
R20-5075-SO	1/2" Dia. X 3/4" Standoff	3	6	8
R20-501-SO	1/2" Dia. X 1" Standoff	3	6	8
R20-502-SO	1/2" Dia. X 2" Standoff	3	6	8
R20-7550-SO	3/4" Dia. X 1/2" Standoff		3	4
R20-7575-SO	3/4" Dia. X 3/4" Standoff	3	6	8
R20-751-SO	3/4" Dia. X 1" Standoff	3	6	8
R20-752-SO	3/4" Dia. X 2" Standoff	3	6	8
R20-754-SO	3/4" Dia. X 4" Standoff		3	6
R20-175-SO	1" Dia. X 3/4" Standoff	3	6	8
R20-11-SO	1" Dia. X 1" Standoff	3	6	8
R20-12-SO	1" Dia. X 2" Standoff	3	6	8
R20-14-SO	1" Dia. X 4" Standoff		3	6
R20-ST3-3	Small Tension Spring - 3" Post	4		
R20-ST3-15	Small Tension Spring - 15" Post		4	4
R20-LTS-3	Large Tension Spring - 3" Post		8	8
R20-XLTS	X-Large Tension Spring - 3" Post			2
R20-1-TSB	1" Dia. Tension Spring Bracket			1
R20-NC	Nylon Cone	3	4	6
R20-SRP	Steel Resting Pin		4	6
R20-APJ	Adjustable Pivot Joint			1
R20-50-JS	1/2" Dia. Jackstand	1	2	3
R20-1-JS	1" Dia. Jackstand		2	3
R20-MSLD	Mini Slide Base	1	2	3
R20-SLD	Slide Base	1	2	3
R20-LB	Locating Block with Base		2	2
R20-112-MT4	1" Sq. x 12" Mini Tower			1
R20-SCT	1/4-20 Small Component Tray	1	1	2
<b>Total Components</b>		<b>47</b>	<b>111</b>	<b>163</b>

# Magnetic Clamping Kits: M8 Thread



Part Numbers	Description	R8-MCK-A	R8-MCK-B	R8-MCK-C
R8-13-M	13mm Dia. Magnet	3	4	6
R8-19-M	19mm Dia. Magnet	3	4	6
R8-25-M	25mm Dia. Magnet	3	4	6
R8-13-PM	13mm Dia. Pin Magnet		2	2
R8-19-PM	19mm Dia. Pin Magnet			2
R8-1315-SO	13mm Dia. X 15mm Standoff		3	3
R8-1320-SO	13mm Dia. X 20mm Standoff	3	6	8
R8-1325-SO	13mm Dia. X 25mm Standoff	3	6	8
R8-1350-SO	13mm Dia. X 50mm Standoff	3	6	8
R8-1915-SO	19mm Dia. X 15mm Standoff		3	3
R8-1920-SO	19mm Dia. X 20mm Standoff	3	6	8
R8-1925-SO	19mm Dia. X 25mm Standoff	3	6	8
R8-1950-SO	19mm Dia. X 50mm Standoff	3	6	8
R8-19100-SO	19mm Dia. X 100mm Standoff		4	6
R8-2520-SO	25mm Dia. X 20mm Standoff	3	6	8
R8-2525-SO	25mm Dia. X 25mm Standoff	3	6	8
R8-2550-SO	25mm Dia. X 50mm Standoff	3	6	8
R8-25100-SO	25mm Dia. X 100mm Standoff		4	6
R8-STS-38	Small Tension Spring - 38mm Post		4	4
R8-LTS-75	Large Tension Spring - 75mm Post	3	8	8
R8-XLTS	X-Large Tension Spring - 75mm Post			2
R8-25-TSB	25mm Dia. Tension Spring Bracket			1
R8-NC	Nylon Cone	3	4	4
R8-SC	Steel Cone		4	4
R8-PJ	Pivot Joint			1
R8-19-JS	19mm Dia. Small Jackstand	1	2	3
R8-25-JS	25mm Dia. Large Jackstand		2	3
R8-SLD	Slide Base	1	3	5
R8-LB	Locating Block with Base		2	2
R8-25300-MT4	25mm Sq. X 300mm Mini Tower			1
R8-SCT	M8 Small Component Tray	1	1	2
<b>Total Components</b>		45	112	152

# Magnetic Clamping Kits: M6 Thread



Part Numbers	Description	R6-MCK-A	R6-MCK-B	R6-MCK-C
R6-13-M	13mm Dia. Magnet	3	4	6
R6-19-M	19mm Dia. Magnet	3	4	6
R6-25-M	25mm Dia. Magnet	3	4	6
R6-13-PM	13mm Dia. Pin Magnet		2	2
R6-19-PM	19mm Dia. Pin Magnet			2
R6-910-SO	9mm Dia. X 10mm Standoff		3	4
R6-1310-SO	13mm Dia. X 10mm Standoff			4
R6-1320-SO	13mm Dia. X 20mm Standoff	3	6	8
R6-1325-SO	13mm Dia. X 25mm Standoff	3	6	8
R6-1350-SO	13mm Dia. X 50mm Standoff	3	6	8
R6-1910-SO	19mm Dia. X 10mm Standoff		3	4
R6-1920-SO	19mm Dia. X 20mm Standoff	3	6	8
R6-1925-SO	19mm Dia. X 25mm Standoff	3	6	8
R6-1950-SO	19mm Dia. X 50mm Standoff	3	6	8
R6-19100-SO	19mm Dia. X 100mm Standoff		3	6
R6-2520-SO	25mm Dia. X 20mm Standoff	3	6	8
R6-2525-SO	25mm Dia. X 25mm Standoff	3	6	8
R6-2550-SO	25mm Dia. X 50mm Standoff	3	6	8
R6-25100-SO	25mm Dia. X 100mm Standoff		3	6
R6-ST3-38	Small Tension Spring - 38mm Post		4	4
R6-LTS-75	Large Tension Spring - 75mm Post	3	8	8
R6-XLTS	X-Large Tension Spring - 75mm Post			2
R6-25-TSB	25mm Dia. Tension Spring Bracket			1
R6-NC	Nylon Cone	3	4	6
R6-SRP	Steel Resting Pin		4	6
R6-APJ	Adjustable Pivot Joint			1
R6-13-JS	13mm Dia. Small Jackstand	1	2	3
R6-25-JS	25mm Dia. Large Jackstand		2	3
R6-MSLD	Mini Slide Base		2	3
R6-SLD	Slide Base	1	2	3
R6-LB	Locating Block with Base		2	2
R6-25300-MT4	25mm sq. x 300mm Mini Tower			1
R6-SCT	M6 Small Component Tray	1	1	2
<b>Total Components</b>		45	111	163

# Magnetic Clamping Kits: M4 Thread



Part Numbers	Description	R4-MCK-A
R4-6-M	6mm Dia. Magnet	3
R4-13-M	13mm Dia. Magnet	3
R4-6-PM	6mm Dia. Pin Magnet	3
R4-65-SO	6mm Dia. X 5mm Standoff	3
R4-610-SO	6mm Dia. X 10mm Standoff	3
R4-625-SO	6mm Dia. X 25mm Standoff	3
R4-95-SO	9mm Dia. X 5mm Standoff	3
R4-910-SO	9mm Dia. X 10mm Standoff	3
R4-925-SO	9mm Dia. X 25mm Standoff	3
R4-625-PSO	6mm Dia. X 25mm Pin Standoff	3
R4-MTS-25	Mini Tension Spring - 25mm Post	2
R4-MTS-50	Mini Tension Spring - 50mm Post	2
R4-WTS-32-25	32mm Wire Tension Spring - 25mm Post	2
R4-WTS-50-50	50mm Wire Tension Spring - 50mm Post	2
R4-ST5-25	Small Tension Spring - 25mm Post	2
R4-MSLD	Mini Slide Base	1
R4-ARP	Aluminum Resting Pin	4
R4-CV	Corner Viewer	1
R4-MCV	Mini Corner Viewer	1
R4-PC	Pusher Clamp	1
AX-BOX	Organizer Box	1
<b>Total Components</b>		<b>49</b>

# Vacuum Clamping Kits: 1/4-20 Thread



Part Numbers	Description	R20-VCK-A	R20-VCK-B
R20-10-SC	10mm Suction Cup	3	3
R20-20-SC	20mm Suction Cup	4	4
R20-30-SC	30mm Suction Cup		2
R20-50-SC	50mm Suction Cup	1	1
R20-20-EXSC	20mm Exposed Suction Cup	2	2
R-9P-M	9-Port Manifold	1	1
R-VP	Vacuum Pump Assembly	1	1
R-12-VH	Vacuum Hose 12" Long	20	20
R-PMCD2202	Straight Hose Barb Connector	1	1
R-PMC23028	Elbow Connector	8	8
R20-37550-SO	3/8" Dia. x 1/2" Standoff	3	3
R20-5075-SO	1/2" Dia. X 3/4" Standoff		6
R20-501-SO	1/2" Dia. X 1" Standoff	4	6
R20-502-SO	1/2" Dia. X 2" Standoff		6
R20-7550-SO	3/4" Dia. X 1/2" Standoff	3	3
R20-7575-SO	3/4" Dia. X 3/4" Standoff		6
R20-751-SO	3/4" Dia. X 1" Standoff	4	6
R20-752-SO	3/4" Dia. X 2" Standoff	4	6
R20-753-SO	3/4" Dia. X 3" Standoff		3
R20-175-SO	1" Dia. X 3/4" Standoff	6	6
R20-11-SO	1" Dia. X 1" Standoff	4	6
R20-12-SO	1" Dia. X 2" Standoff	4	6
R20-14-SO	1" Dia. X 4" Standoff	3	3
R20-ST5-15	Small Tension Spring - 1.5" Post	4	4
R20-LTS-3	Large Tension Spring - 3" Post	4	8
R20-NC	Nylon Cone	4	4
R20-SRP	Steel Resting Pin	4	4
R20-50-JS	1/2" Dia. Jackstand		2
R20-1-JS	1" Dia. Jackstand	2	2
R20-MSLD	Mini Slide Base	2	2
R20-SLD	Slide Base	2	2
R20-LB	Locating Block with Base	2	2
R20-SCT	1/4-20 Small Component Tray	1	1
R-VCT	Vacuum Component Tray	1	1
<b>Total Components</b>		102	141

# Vacuum Clamping Kits: M8 Thread



Part Numbers	Description	R8-VCK-A	R8-VCK-B
R8-10-SC	10mm Suction Cup	3	3
R8-20-SC	20mm Suction Cup	4	4
R8-30-SC	30mm Suction Cup	2	2
R8-50-SC	50mm Suction Cup	1	1
R8-20-EXSC	20mm Exposed Suction Cup	2	2
R-9P-M	9-Port Manifold	1	1
R-VP	Vacuum Pump Assembly	1	1
R-12-VH	Vacuum Hose 12" Long	20	20
R-PMCD2202	Straight Hose Barb Connector	1	1
R-PMC23028	Elbow Connector	8	11
R8-1320-SO	13mm Dia. X 20mm Standoff		6
R8-1325-SO	13mm Dia. X 25mm Standoff	6	6
R8-1350-SO	13mm Dia. X 50 mm Standoff	6	6
R8-1915-SO	19mm Dia. X 15mm Standoff	3	3
R8-1920-SO	19mm Dia. X 20mm Standoff		6
R8-1925-SO	19mm Dia. X 25mm Standoff	6	6
R20-1950-SO	19mm Dia. X 50mm Standoff		6
R8-1975-SO	19mm Dia. X 75mm Standoff	3	2
R8-2520-SO	25mm Dia. X 20mm Standoff		6
R8-2525-SO	25mm Dia. X 25mm Standoff	6	6
R8-2550-SO	25mm Dia. X 50mm Standoff		6
R8-25100-SO	25mm Dia. X 100mm Standoff		3
R8-STS-38	Small Tension Spring -38mm Post	4	4
R8-LTS-75	Large Tension Spring -75mm Post	8	8
R8-NC	Nylon Cone	4	4
R8-SC	Steel Cone	4	4
R8-19-JS	19mm Dia. Small Jackstand	2	2
R8-25-JS	25mm Dia. Large Jackstand		2
R8-SLD	Slide Base		3
R8-LB	Locating Block with Base		2
R8-SCT	M8 Small Component Tray	1	1
R-VCT	Vacuum Component Tray	1	1
<b>Total Components</b>		97	139

# Vacuum Clamping Kits: M6 Thread



Part Numbers	Description	R6-VCK-A	R6-VCK-B
R6-10-SC	10mm Suction Cup	3	3
R6-20-SC	20mm Suction Cup	4	4
R6-30-SC	30mm Suction Cup		2
R6-50-SC	50mm Suction Cup	1	1
R6-20-EXSC	20mm Exposed Suction Cup	2	2
R-9P-M	9-Port Manifold	1	1
R-VP	Vacuum Pump Assembly	1	1
R-12-VH	Vacuum Hose 12" Long	20	20
R-PMCD2202	Straight Hose Barb Connector	8	8
R-PMC23028	Elbow Connector	1	1
R6-910-SO	9mm Dia. X 10mm Standoff	3	3
R6-1320-SO	13mm Dia. X 20mm Standoff		6
R6-1325-SO	13mm Dia. X 25mm Standoff	4	6
R6-1350-SO	13mm Dia. X 50mm Standoff		6
R6-1910-SO	19mm Dia. X 10mm Standoff	3	3
R6-1920-SO	19mm Dia. X 20mm Standoff		6
R6-1925-SO	19mm Dia. X 25mm Standoff	4	6
R6-1950-SO	19mm Dia. X 50mm Standoff	4	6
R6-19100-SO	19mm Dia. X 100mm Standoff		3
R6-2520-SO	25mm Dia. X 20mm Standoff	6	6
R6-2525-SO	25mm Dia. X 25mm Standoff	4	6
R6-2550-SO	25mm Dia. X 50mm Standoff	4	6
R6-25100-SO	25mm Dia. X 100mm Standoff	3	3
R6-ST3-38	Small Tension Spring - 38mm Post	4	4
R6-LTS-75	Large Tension Spring - 75mm Post	4	8
R6-NC	Nylon Cone	4	4
R6-SRP	Steel Resting Pin	4	4
R6-13-JS	13mm Dia. Small Jackstand		2
R6-25-JS	25mm Dia. Large Jackstand	2	2
R6-MSLD	Mini Slide Base	2	2
R6-SLD	Slide Base	2	2
R6-LB	Locating Block with Base	2	2
R6-SCT	M6 Small Component Tray	1	1
R-VCT	Vacuum Component Tray	1	1
<b>Total Components</b>		<b>102</b>	<b>141</b>

# Vision Clamping Kits: 1/4-20 Thread



RA20-VK-A

Part Numbers	Description	RA20-VK-A	RA20-VK-B	RA20-VK-C
R20-2550-SO	1/4" Dia. X 1/2" Standoff	3	6	8
R20-251-SO	1/4" Dia. X 1" Standoff	3	6	8
R20-37525-SO	3/8" Dia. X 1/4" Standoff	3	3	8
R20-37550-SO	3/8" Dia. X 1/2" Standoff	3	6	8
R20-37575-SO	3/8" Dia. X 3/4" Standoff		6	8
R20-3751-SO	3/8" Dia. X 1" Standoff	3	6	6
R20-5050-SO	1/2" Dia. X 1/2" Standoff	3	6	6
R20-501-SO	1/2" Dia. X 1" Standoff		6	6
R20-2550-PSO	1/4" Dia. X 1/2" Pin Standoff	2	4	6
R20-37550-PSO	3/8" Dia. X 1/2" Pin Standoff	2	4	6
R20-501-PSO	1/2" Dia. X 1" Pin Standoff		4	4
R20-MTS-1	Mini Tension Spring - 1" Post	2	3	6
R20-MTS-2	Mini Tension Spring - 2" Post		3	6
R20-ST5-15	Small Tension Spring - 1.5" Post		6	6
R20-WTS-125-1	1.25" Wire Tension Spring - 1" Post	3	3	4
R20-WTS-2-2	2" Wire Tension Spring - 2" Post	3	3	4
R20-SRP	Steel Resting Pin	4	4	4
R20-CV	Corner Viewer		1	1
R20-MCV	Mini Corner Viewer	1		
R20-50-JS	1/2" Dia. Small Jackstand	1	2	2
R20-MSLD	Mini Slide Base	1	2	2
R20-PC	Pusher Clamp		1	1
R20-LB	Locating Block with Base	1		
R20-SCT	1/4-20 Small Component Tray		1	1
AX-BOX	Organizer Box	1		
<b>Total Components</b>		<b>39</b>	<b>86</b>	<b>111</b>

# Vision Clamping Kits: M6 Thread



RA6-VK-C

Part Numbers	Description	RA6-VK-A	RA6-VK-B	RA6-VK-C
R6-610-SO	6mm Dia. X 10mm Standoff	3	6	8
R6-625-SO	6mm Dia. X 25mm Standoff	3	6	8
R6-95-SO	9mm Dia. X 5mm Standoff	3	3	8
R6-910-SO	9mm Dia. X 10mm Standoff	3	6	8
R6-920-SO	9mm Dia. X 20mm Standoff		6	8
R6-925-SO	9mm Dia. X 25mm Standoff	3	6	6
R6-1310-SO	13mm Dia. X 10mm Standoff	3	6	6
R6-1325-SO	13mm Dia. X 25mm Standoff		6	6
R6-610-PSO	6mm Dia. X 10mm Pin Standoff	2	4	6
R6-910-PSO	9mm Dia. X 10mm Pin Standoff	2	4	6
R6-1325-PSO	13mm Dia. X 25mm Pin Standoff		4	4
R6-MTS-25	Mini Tension Spring - 25mm Post	2	3	6
R6-MTS-50:	Mini Tension Spring - 50mm Post		3	6
R6-STS-38	Small Tension Spring - 38mm Post		6	6
R6-WTS-32-25	32mm Wire Tension Spring - 25mm Post	3	3	4
R6-WTS-50-50	50mm Wire Tension Spring - 50mm Post	3	3	4
R6-SRP	Steel Resting Pin	4	4	4
R6-CV	Corner Viewer	1	1	1
R6-13-JS	13mm Dia. Jackstand	1	2	2
R6-MSLD	Mini Slide Base	1	2	2
R6-LB	Locating Block with Base	1		
R6-PC	Pusher Clamp		1	1
R6-SCT	M6 Small Component Tray		1	1
AX-BOX	Organizer Box	1		
<b>Total Components</b>		<b>39</b>	<b>86</b>	<b>111</b>

# Vision Clamping Kits: M4 Thread



Part Numbers	Description	RA4-VK-A	RA4-VK-B	RA4-VK-C
R4-65-SO	6mm Dia. X 5mm Standoff		3	6
R4-610-SO	6mm Dia. X 10mm Standoff	3	6	8
R4-625-SO	6mm Dia. X 25mm Standoff	3	6	8
R4-95-SO	9mm Dia. X 5mm Standoff	3	3	4
R4-910-SO	9mm Dia. X 10mm Standoff	3	6	8
R4-920-SO	9mm Dia. X 20mm Standoff		6	8
R4-925-SO	9mm Dia. X 25mm Standoff	3	6	8
R4-1210-SO	12mm Dia. X 10mm Standoff	3	6	8
R4-1225-SO	12mm Dia. X 25mm Standoff		6	8
R4-610-PSO	6mm Dia. X 10mm Pin Standoff	2	4	6
R4-910-PSO	9mm Dia. X 10mm Pin Standoff	2	4	6
R4-1210-PSO	12mm Dia. X 10mm Pin Standoff		4	6
R4-MTS-25	Mini Tension Spring - 25mm Post	3	4	8
R4-WTS-32-25	32mm Wire Tension Spring - 25mm Post	3	4	8
R4-WTS-50-50	50mm Wire Tension Spring - 50mm Post	2	4	8
R4-ST5-50	Small Tension Spring - 50mm Post	2	4	8
R4-MSLD	Mini Slide Base	1	2	2
R4-MJS	Mini JackStand	2	2	2
R4-ARP	Aluminum Resting Pin	4	4	6
R4-LB	Locating Block with Base		1	1
R4-MCV	Mini Corner Viewer	1	1	1
R4-PC	Pusher Clamp		1	2
R4-MCT	M4 Mini Component Tray		1	1
AX-BOX	Organizer Box	1		
<b>Total Components</b>		<b>41</b>	<b>88</b>	<b>131</b>

## Small Tension Spring

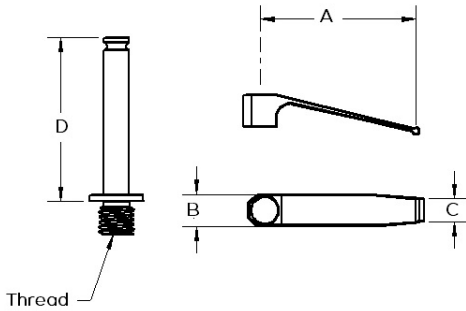

Part Number	Thread	A	B	C	D
R20-ST5-15	1/4-20	15"	0.3"	0.125"	15"
R20-ST5-3	1/4-20	15"	0.3"	0.125"	3"
R20-ST5-15-RT (Rubber Tipped)	1/4-20	15"	0.3"	0.125"	15"
R20-ST5-3-RT (Rubber Tipped)	1/4-20	15"	0.3"	0.125"	3"
R8-ST5-38	M8	38 mm	7.62 mm	3.29 mm	38 mm
R8-ST5-75	M8	38 mm	7.62 mm	3.29 mm	75 mm
R8-ST5-38-RT (Rubber Tipped)	M8	38 mm	7.62 mm	3.29 mm	38 mm
R8-ST5-75-RT (Rubber Tipped)	M8	38 mm	7.62 mm	3.29 mm	75 mm
R6-ST5-38	M6	38 mm	7.62 mm	3.29 mm	38 mm
R6-ST5-75	M6	38 mm	7.62 mm	3.29 mm	75 mm
R6-ST5-38-RT (Rubber Tipped)	M6	38 mm	7.62 mm	3.29 mm	38 mm
R6-ST5-75-RT (Rubber Tipped)	M6	38 mm	7.62 mm	3.29 mm	75 mm
R4-ST5-25	M4	38 mm	7.62 mm	3.29 mm	25 mm
R4-ST5-50	M4	38 mm	7.62 mm	3.29 mm	50 mm
R4-ST5-25-RT (Rubber Tipped)	M4	38 mm	7.62 mm	3.29 mm	25 mm
R4-ST5-50-RT (Rubber Tipped)	M4	38 mm	7.62 mm	3.29 mm	50 mm

## Large Tension Spring

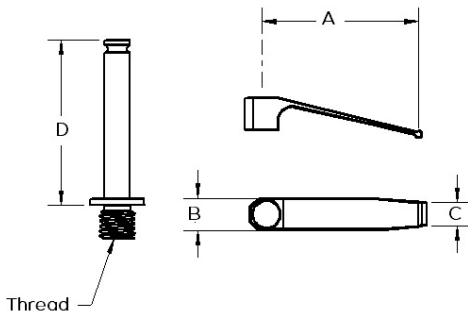

Part Number	Thread	A	B	C	D
R20-LTS-15	1/4-20	2.30"	0.5"	0.3"	15"
R20-LTS-3	1/4-20	2.30"	0.5"	0.3"	3"
R20-LTS-15-RT (Rubber Tipped)	1/4-20	2.30"	0.5"	0.3"	15"
R20-LTS-3-RT (Rubber Tipped)	1/4-20	2.30"	0.5"	0.3"	3"
R8-LTS-38	M8	58 mm	12.7 mm	6.5 mm	38 mm
R8-LTS-75	M8	58 mm	12.7 mm	6.5 mm	75 mm
R8-LTS-38-RT (Rubber Tipped)	M8	58 mm	12.7 mm	6.5 mm	38 mm
R8-LTS-75-RT (Rubber Tipped)	M8	58 mm	12.7 mm	6.5 mm	75 mm
R6-LTS-38	M6	58 mm	12.7 mm	6.5 mm	38 mm
R6-LTS-75	M6	58 mm	12.7 mm	6.5 mm	75 mm
R6-LTS-38-RT (Rubber Tipped)	M6	58 mm	12.7 mm	6.5 mm	38 mm
R6-LTS-75-RT (Rubber Tipped)	M6	58 mm	12.7 mm	6.5 mm	75 mm
R4-LTS-25	M4	58 mm	12.7 mm	6.5 mm	25 mm
R4-LTS-50	M4	58 mm	12.7 mm	6.5 mm	50 mm
R4-LTS-25-RT (Rubber Tipped)	M4	58 mm	12.7 mm	6.5 mm	25 mm
R4-LTS-50-RT (Rubber Tipped)	M4	58 mm	12.7 mm	6.5 mm	50 mm

Part Number	Thread	A	B	C	D
R20-XLTS	1/4-20	3.42"	0.75"	0.375"	3"
R20-XLTS-RT (Rubber Tipped)	1/4-20	3.42"	0.75"	0.375"	3"
R8-XLTS	M8	87 mm	19 mm	9.5 mm	76 mm
R20-XLTS-RT (Rubber Tipped)	M8	87 mm	19 mm	9.5 mm	76 mm
R6-XLTS	M6	87 mm	19 mm	9.5 mm	76 mm
R6-XLTS-RT (Rubber Tipped)	M6	87 mm	19 mm	9.5 mm	76 mm

## X-Large Tension Spring

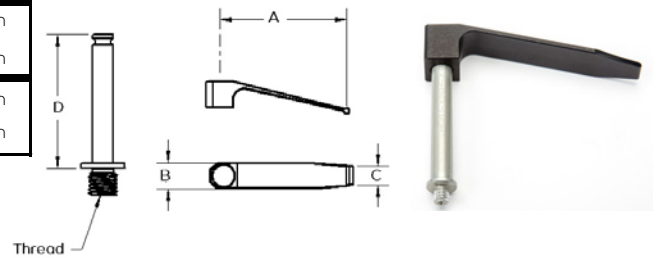

Part Number	Thread	A	B	C	D
R20-XLTSP	1/4-20	3.625"	0.75"	0.275"	3"
R8-XLTSP	M8	92 mm	19 mm	7 mm	76 mm
R6-XLTSP	M6	92 mm	19 mm	7 mm	76 mm

## X-Large Tension Spring with Plunger

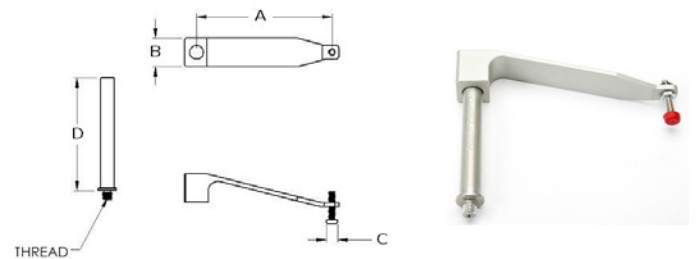

Part Number	Thread	A	B
R20-WTS-125-1	1/4-20	1.25"	1"
R20-WTS-2-2	1/4-20	2"	2"
R20-WTS-125-2	1/4-20	1.25"	2"
R20-WTS-2-1	1/4-20	2"	1"
R20-WTS-125-1-RT (Rubber Tipped)	1/4-20	1.25"	1"
R20-WTS-2-2-RT (Rubber Tipped)	1/4-20	2"	2"
R20-WTS-125-2-RT (Rubber Tipped)	1/4-20	1.25"	2"
R20-WTS-2-1-RT (Rubber Tipped)	1/4-20	2"	1"
R6-WTS-32-25	M6	32 mm	25 mm
R6-WTS-50-50	M6	50 mm	50 mm
R6-WTS-32-50	M6	32 mm	50 mm
R6-WTS-50-25	M6	50 mm	25 mm
R6-WTS-32-25-RT (Rubber Tipped)	M6	32 mm	25 mm
R6-WTS-50-50-RT (Rubber Tipped)	M6	50 mm	50 mm
R6-WTS-32-50-RT (Rubber Tipped)	M6	32 mm	50 mm
R6-WTS-50-25-RT (Rubber Tipped)	M6	50 mm	25 mm
R4-WTS-32-25	M4	32 mm	25 mm
R4-WTS-50-50	M4	50 mm	50 mm
R4-WTS-50-25	M4	50 mm	25 mm
R4-WTS-32-50	M4	32 mm	50 mm
R4-WTS-32-25-RT (Rubber Tipped)	M4	32 mm	25 mm
R4-WTS-50-50-RT (Rubber Tipped)	M4	50 mm	50 mm
R4-WTS-50-25-RT (Rubber Tipped)	M4	50 mm	25 mm
R4-WTS-32-50-RT (Rubber Tipped)	M4	32 mm	50 mm

## Wire Tension Springs

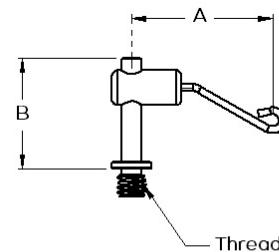

## Mini Tension Springs

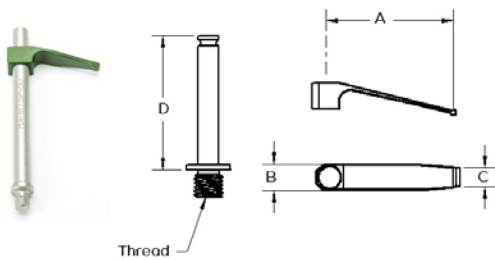

Part Number	Thread	A	B	C	D
R20-MTS-1	1/4-20	0.84"	0.25"	0.08"	1"
R20-MTS-2	1/4-20	0.84"	0.25"	0.08"	2"
R20-MTS-1-RT (Rubber Tipped)	1/4-20	0.84"	0.25"	0.08"	1"
R20-MTS-2-RT (Rubber Tipped)	1/4-20	0.84"	0.25"	0.08"	2"
R6-MTS-25	M6	21 mm	6.3 mm	2 mm	25 mm
R6-MTS-50	M6	21 mm	6.3 mm	2 mm	50 mm
R6-MTS-25-RT (Rubber Tipped)	M6	21 mm	6.3 mm	2 mm	25 mm
R6-MTS-50-RT (Rubber Tipped)	M6	21 mm	6.3 mm	2 mm	50 mm
R4-MTS-25	M4	21 mm	6.3 mm	2 mm	25 mm
R4-MTS-50	M4	21 mm	6.3 mm	2 mm	50 mm
R4-MTS-25-RT (Rubber Tipped)	M4	21 mm	6.3 mm	2 mm	25 mm
R4-MTS-50-RT (Rubber Tipped)	M4	21 mm	6.3 mm	2 mm	50 mm

## Standoffs

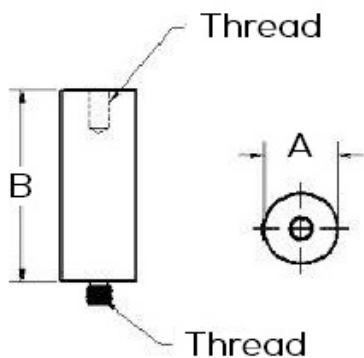

Part Number	Thread	A	B
R20-2525-SO (No female thread)	1/4-20	0.25"	0.25"
R20-2550-SO (No female thread)	1/4-20	0.25"	0.50"
R20-2575-SO (No female thread)	1/4-20	0.25"	0.75"
R20-251-SO (No female thread)	1/4-20	0.25"	1"
R20-37525-SO (No female thread)	1/4-20	0.375"	0.25"
R20-37550-SO	1/4-20	0.375"	0.50"
R20-37575-SO	1/4-20	0.375"	0.75"
R20-3751-SO	1/4-20	0.375"	1"
R20-5025-SO (No female thread)	1/4-20	0.50"	0.25"
R20-5050-SO	1/4-20	0.50"	0.50"
R20-5075-SO	1/4-20	0.50"	0.75"
R20-501-SO	1/4-20	0.50"	1"
R20-502-SO	1/4-20	0.50"	2"
R20-503-SO	1/4-20	0.50"	3"
R20-504-SO	1/4-20	0.50"	4"
R20-505-SO	1/4-20	0.50"	5"
R20-506-SO	1/4-20	0.50"	6"
R20-7550-SO	1/4-20	0.75"	0.50"
R20-7575-SO	1/4-20	0.75"	0.75"
R20-751-SO	1/4-20	0.75"	1"
R20-752-SO	1/4-20	0.75"	2"
R20-753-SO	1/4-20	0.75"	3"
R20-754-SO	1/4-20	0.75"	4"
R20-755-SO	1/4-20	0.75"	5"
R20-756-SO	1/4-20	0.75"	6"
R20-150-SO	1/4-20	1"	0.50"
R20-175-SO	1/4-20	1"	0.75"
R20-11-SO	1/4-20	1"	1"
R20-12-SO	1/4-20	1"	2"
R20-13-SO	1/4-20	1"	3"
R20-14-SO	1/4-20	1"	4"
R20-15-SO	1/4-20	1"	5"
R20-16-SO	1/4-20	1"	6"

## Standoffs Continued

Part Number	Thread	A	B
R8-1315-SO	M8	13 mm	15 mm
R8-1320-SO	M8	13 mm	20 mm
R8-1325-SO	M8	13 mm	25 mm
R8-1350-SO	M8	13 mm	50 mm
R8-1375-SO	M8	13 mm	75 mm
R8-13100-SO	M8	13 mm	100 mm
R8-13150-SO	M8	13 mm	150 mm
R8-1915-SO	M8	19 mm	15 mm
R8-1920-SO	M8	19 mm	20 mm
R8-1925-SO	M8	19 mm	25 mm
R8-1950-SO	M8	19 mm	50 mm
R8-1975-SO	M8	19 mm	75 mm
R8-19100-SO	M8	19 mm	100 mm
R8-19150-SO	M8	19 mm	150 mm
R8-2515-SO	M8	25 mm	15 mm
R8-2520-SO	M8	25 mm	20 mm
R8-2525-SO	M8	25 mm	25 mm
R8-2550-SO	M8	25 mm	50 mm
R8-25100-SO	M8	25 mm	100 mm
R8-25150-SO	M8	25 mm	150 mm
R8-3825-SO	M8	38 mm	25 mm
R8-3850-SO	M8	38 mm	50 mm
R8-38150-SO	M8	38 mm	150 mm
R6-65-SO (No female thread)	M6	6 mm	5 mm
R6-610-SO (No female thread)	M6	6 mm	10 mm
R6-620-SO (No female thread)	M6	6 mm	20 mm
R6-625-SO (No female thread)	M6	6 mm	25 mm
R6-95-SO (No female thread)	M6	9 mm	5 mm
R6-910-SO	M6	9 mm	10 mm
R6-920-SO	M6	9 mm	20 mm
R6-925-SO	M6	9 mm	25 mm
R6-135-SO (No female thread)	M6	13 mm	5 mm
R6-1310-SO	M6	13 mm	10 mm
R6-1315-SO	M6	13 mm	15 mm
R6-1320-SO	M6	13 mm	20 mm
R6-1325-SO	M6	13 mm	25 mm
R6-1350-SO	M6	13 mm	50 mm
R6-1375-SO	M6	13 mm	75 mm
R6-13100-SO	M6	13 mm	100 mm
R6-13125-SO	M6	13 mm	125 mm
R6-13150-SO	M6	19 mm	150 mm
R6-1910-SO	M6	19 mm	10 mm
R6-1915-SO	M6	19 mm	15 mm
R6-1920-SO	M6	19 mm	20 mm
R6-1925-SO	M6	19 mm	25 mm
R6-1950-SO	M6	19 mm	50 mm
R6-1975-SO	M6	19 mm	75 mm
R6-19100-SO	M6	19 mm	100 mm
R6-19125-SO	M6	19 mm	125 mm

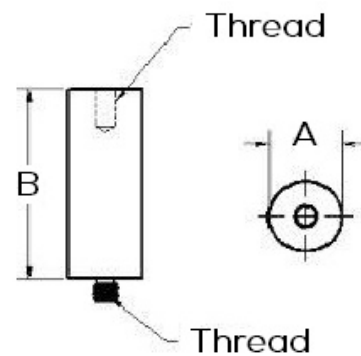

## Standoffs Continued

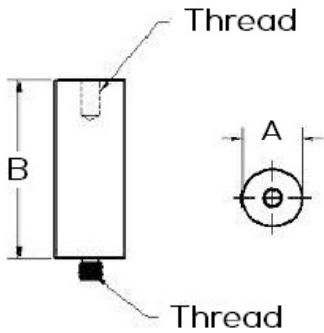

Part Number	Thread	A	B
R6-19150-SO	M6	19 mm	150 mm
R6-2520-SO	M6	25 mm	20 mm
R6-2525-SO	M6	25 mm	25 mm
R6-2550-SO	M6	25 mm	50 mm
R6-25100-SO	M6	25 mm	100 mm
R6-25125-SO	M6	25 mm	125 mm
R6-25150-SO	M6	25 mm	150 mm
R4-65-SO (No female thread)	M4	6 mm	5 mm
R4-610-SO (No female thread)	M4	6 mm	10 mm
R4-620-SO (No female thread)	M4	6 mm	20 mm
R4-625-SO (No female thread)	M4	6 mm	25 mm
R4-95-SO (No female thread)	M4	9 mm	5 mm
R4-910-SO	M4	9 mm	10 mm
R4-920-SO	M4	9 mm	20 mm
R4-925-SO	M4	9 mm	25 mm
R4-125-SO (No female thread)	M4	12 mm	5 mm
R4-1210-SO	M4	12 mm	10 mm
R4-1220-SO	M4	12 mm	20 mm
R4-1225-SO	M4	12 mm	25 mm

## Pin Standoffs

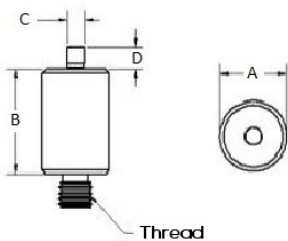

Part Number	Thread	A	B	C	D
R20-2525-PSO	1/4-20	0.25"	0.25"	0.062"	0.15"
R20-2550-PSO	1/4-20	0.25"	0.50"	0.062"	0.15"
R20-251-PSO	1/4-20	0.25"	1"	0.062"	0.15"
R20-37525-PSO	1/4-20	0.375"	0.25"	0.062"	0.15"
R20-37550-PSO	1/4-20	0.375"	0.50"	0.062"	0.15"
R20-3751-PSO	1/4-20	0.375"	1"	0.062"	0.15"
R20-5025-PSO	1/4-20	0.50"	0.25"	0.062"	0.15"
R20-5075-PSO	1/4-20	0.50"	0.75"	0.125"	0.15"
R20-501-PSO	1/4-20	0.50"	1"	0.125"	0.15"
R20-7575-PSO	1/4-20	0.75"	0.75"	0.125"	0.15"
R20-175-PSO	1/4-20	1"	0.75"	0.125"	0.15"
R20-11-PSO	1/4-20	1"	1"	0.125"	0.15"
R8-1320-PSO	M8	13 mm	20 mm	3.2 mm	3.8 mm
R8-1325-PSO	M8	13 mm	25 mm	3.2 mm	3.8 mm
R8-1920-PSO	M8	19 mm	20 mm	3.2 mm	3.8 mm
R6-1320-PSO	M6	13 mm	20 mm	3.2 mm	3.8 mm
R6-1325-PSO	M6	13 mm	25 mm	3.2 mm	3.8 mm
R6-1920-PSO	M6	19 mm	20 mm	3.2 mm	3.8 mm
R6-1925-PSO	M6	19 mm	25 mm	3.2 mm	3.8 mm
R6-65-PSO	M6	6 mm	5 mm	2 mm	3.8 mm
R6-610-PSO	M6	6 mm	10 mm	2 mm	3.8 mm
R6-625-PSO	M6	6 mm	25 mm	2 mm	3.8 mm
R6-95-PSO	M6	9 mm	5 mm	2 mm	3.8 mm
R6-910-PSO	M6	9 mm	10 mm	2 mm	3.8 mm
R6-925-PSO	M6	9 mm	25 mm	2 mm	3.8 mm

Part Number	Thread	A	B	C	D
R4-65-PSO	M4	6 mm	5 mm	2 mm	3.8 mm
R4-610-PSO	M4	6 mm	10 mm	2 mm	3.8 mm
R4-625-PSO	M4	6 mm	25 mm	2 mm	3.8 mm
R4-95-PSO	M4	9 mm	5 mm	2 mm	3.8 mm
R4-910-PSO	M4	9 mm	10 mm	2 mm	3.8 mm
R4-925-PSO	M4	9 mm	25 mm	2 mm	3.8 mm
R4-125-PSO	M4	12 mm	5 mm	2 mm	3.8 mm
R4-1210-PSO	M4	12 mm	10 mm	2 mm	3.8 mm
R4-1225-PSO	M4	12 mm	25 mm	2 mm	3.8 mm

## Pin Standoffs Continued



Part Number	Thread	A	B	C	D
R20-502-SLTP	1/4-20	2"	0.50" Dia.	0.250" Dia.	0.045" Rad.
R20-752-SLTP	1/4-20	2"	0.75" Dia.	0.375" Dia.	0.125" Rad.
R8-1350-SLTP	M8	50 mm	13 mm Dia.	6 mm Dia.	1 mm Rad.
R8-1950-SLTP	M8	50 mm	19 mm Dia.	9 mm Dia.	3mm Rad.
R6-1350-SLTP	M6	50 mm	13 mm Dia.	9 mm Dia.	3mm Rad.
R6-1950-SLTP	M6	50 mm	19 mm Dia.	16 mm Dia.	6mm Rad.

## Spring Loaded Tapered Pin Standoffs

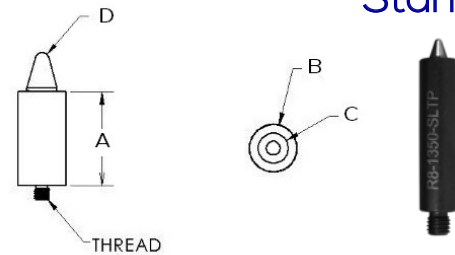

Part Number	Thread	A	B	C
R20-5075-RPSO	1/4-20	0.75"	0.50" Dia.	0.250" Dia.
R20-501-RPSO	1/4-20	1"	0.50" Dia.	0.250" Dia.
R8-1320-RPSO	M8	20 mm	13 mm Dia.	6.3 mm Dia.
R8-1325-RPSO	M8	25 mm	13 mm Dia.	6.3mm Dia.
R6-1320-RPSO	M6	20 mm	13 mm Dia.	6.3 mm Dia.
R6-1325-RPSO	M6	25 mm	13 mm Dia.	6.3 mm Dia.

## Rounded Pin Standoffs

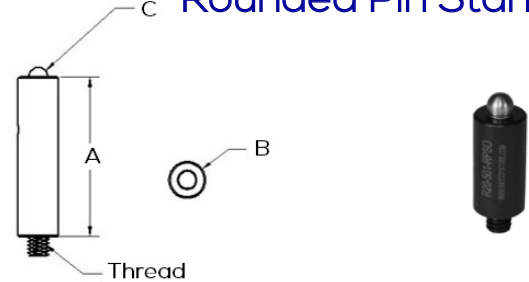

Part Number	Thread	A	B	C
R20-502-SLRP	1/4-20	2"	0.50" Dia.	0.250" Dia.
R20-752-SLRP	1/4-20	2"	0.75" Dia.	0.375" Dia.
R8-1350-SLRP	M8	50 mm	13 mm Dia.	6.3 mm Dia.
R8-1950-SLRP	M8	50 mm	19 mm Dia.	9.5 mm Dia.
R6-1350-SLRP	M6	50 mm	13 mm Dia.	6.3 mm Dia.
R6-1950-SLRP	M6	50 mm	19 mm Dia.	9.5 mm Dia.

## Spring Loaded Rounded Pin Standoffs

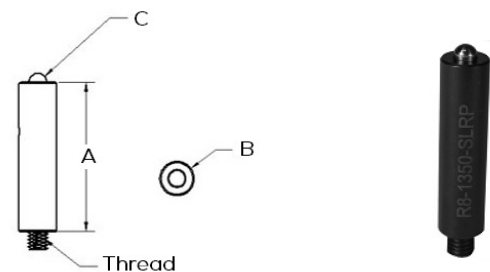

Part Number	Thread	A	B	C	D
R20-5050-SPS	1/4-20	0.50"	0.50"	0.069"	0.008"
R20-751-SPS	1/4-20	0.75"	1"	0.168"	0.027"
R8-1925-SPS	M8	19 mm	25 mm	4.3 mm	0.7 mm
R6-1310-SPS	M6	13 mm	10 mm	1.8 mm	0.2 mm
R6-1925-SPS	M6	19 mm	25 mm	4.3 mm	0.2 mm
R4-1210-SPS	M4	12 mm	10 mm	1.8 mm	0.2 mm

## Spring Locating Pin Standoffs

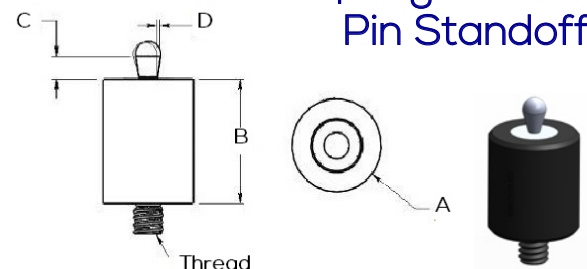

\*Optional pin material and side forces available

## Rotational Spring Locating Pin Standoff

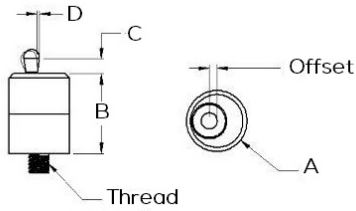

Part Number	Thread	A	B	C	D
R20-75-CSPS	1/4-20	0.75"	1"	0.168"	0.027"
R8-19-CSPS	M8	19 mm	25 mm	4.3 mm	0.7 mm
R6-19-CSPS	M6	19 mm	25 mm	4.3 mm	0.7 mm
R4-19-CSPS	M4	19 mm	25 mm	4.3 mm	0.7 mm

\*Optional pin material and side forces available

## Magnetic Standoffs

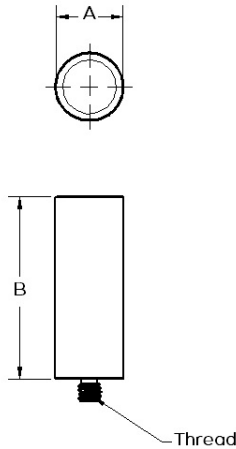

Part Number	Thread	A	B
R20-50-M	1/4-20	0.50"	1"
R20-75-M	1/4-20	0.75"	1"
R20-1-M	1/4-20	1"	1"
R20-125-M	1/4-20	1.25"	1"
R8-13-M	M8	13 mm	25 mm
R8-19-M	M8	19 mm	25 mm
R8-25-M	M8	25 mm	25 mm
R8-32-M	M8	32 mm	25 mm
R6-13-M	M6	13 mm	25 mm
R6-19-M	M6	19 mm	25 mm
R6-25-M	M6	25 mm	25 mm
R4-6-M	M4	6 mm	25 mm
R4-13-M	M4	13 mm	25 mm

## Magnetic Pin Standoffs

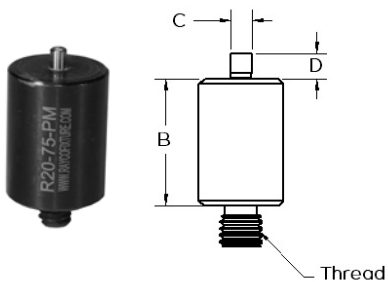

Part Number	Thread	A	B	C	D
R20-50-PM	1/4-20	0.50"	1"	0.125"	0.150"
R20-75-PM	1/4-20	0.75"	1"	0.125"	0.150"
R20-1-PM	1/4-20	1"	1"	0.125"	0.150"
R8-13-PM	M8	13 mm	25 mm	3 mm	3.8 mm
R8-19-PM	M8	19 mm	25 mm	3 mm	3.8 mm
R8-25-PM	M8	25 mm	25 mm	3 mm	3.8 mm
R6-13-PM	M6	13 mm	25 mm	3 mm	3.8 mm
R6-19-PM	M6	19 mm	25 mm	3 mm	3.8 mm
R6-25-PM	M6	25 mm	25 mm	3 mm	3.8 mm
R4-6-PM	M4	6 mm	25 mm	2 mm	3.8 mm
R4-13-PM	M4	13 mm	25 mm	2 mm	3.8 mm

Part Number	Thread	A	B	C	D
R20-50-VMB	1/4-20	0.50"	3"	1"	1.50"
R20-75-VMB	1/4-20	0.75"	3"	1"	1.50"
R20-1-VMB	1/4-20	1"	3"	1"	1.50"
R20-125-VMB	1/4-20	1.25"	3"	1"	1.50"
R8-13-VMB	M8	13 mm	75 mm	25 mm	36 mm
R8-19-VMB	M8	19 mm	75 mm	25 mm	36 mm
R8-25-VMB	M8	25 mm	75 mm	25 mm	36 mm
R8-32-VMB	M8	32 mm	75 mm	25 mm	36 mm
R6-13-VMB	M6	13 mm	75 mm	25 mm	36 mm
R6-19-VMB	M6	19 mm	75 mm	25 mm	36 mm
R6-25-VMB	M6	25 mm	75 mm	25 mm	36 mm

## V-Magnets with Base

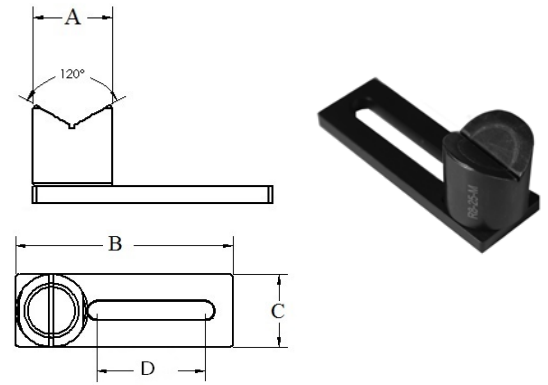

Part Number	Thread	A	B
R20-50-VM	1/4-20	0.50"	1"
R20-75-VM	1/4-20	0.75"	1"
R20-1-VM	1/4-20	1"	1"
R20-125-VM	1/4-20	1.25"	1"
R8-13-VM	M8	13 mm	25 mm
R8-19-VM	M8	19 mm	25 mm
R8-25-VM	M8	25 mm	25 mm
R8-32-VM	M8	32 mm	25 mm
R6-13-VM	M6	13 mm	25 mm
R6-19-VM	M6	19 mm	25 mm
R6-25-VM	M6	25 mm	25 mm

## V-Magnets

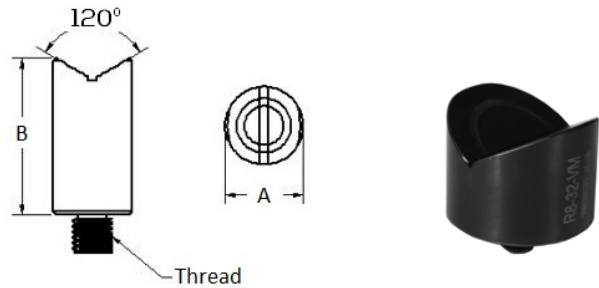

Part Number	Thread	A	B	C
R20-11-RS	1/4-20	1"	0.50"	1"
R6-2525-RS	M6	25 mm	13 mm	25 mm

## Rotating Standoffs\*

\* Used for holding parts against stop

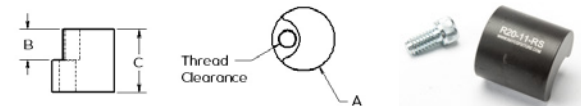

Part Number	Thread 1	A	B	Thread 2
R20-6-SOA	1/4-20	1"	1"	M6
R20-8-SOA	1/4-20	1"	1"	M8
R20-10-SOA	1/4-20	1"	1"	M10
R20-12-SOA	1/4-20	1"	1"	M12
R20-516-SOA	1/4-20	1"	1"	5/16-18
R20-38-SOA	1/4-20	1"	1"	3/8-16
R8-14-SOA	M8	25 mm	25 mm	1/4-20
R6-20-SOA	M6	25 mm	25 mm	1/4-20
R6-8-SOA	M6	25 mm	25 mm	M8
R4-14-SOA	M4	19 mm	15 mm	1/4-20

## Standoff Adapters

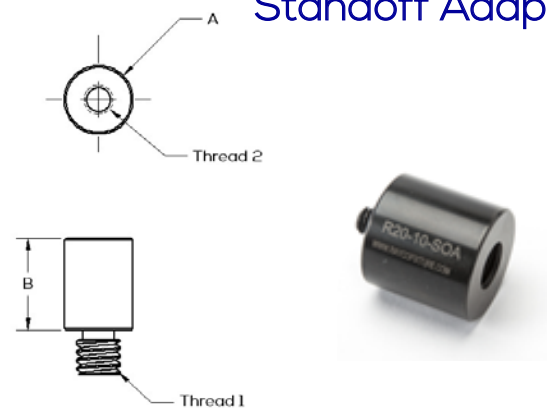

## Adjustable Height Stands

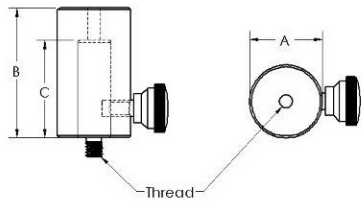

Part Number	Thread	A	B	C
R20-AHS	1/4-20	1.125"	2"	1.5"
R8-AHS	M8	28.5 mm	50 mm	38 mm
R6-AHS	M6	28.5 mm	50 mm	38mm

## Adjustable V-Height Stands

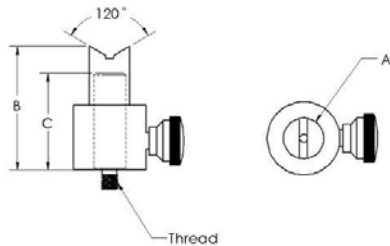

Part Number	Thread	A	B	C
R20-50-AHVS	1/4-20	0.625"	1.9"	1.5"
R20-1-AHVS	1/4-20	1.125"	2"	1.5"
R8-12-AHVS	M8	16 mm	48.5 mm	38 mm
R8-25-AHVS	M8	25 mm	50 mm	38 mm
R6-12-AHVS	M6	16 mm	48.5 mm	38 mm
R6-25-AHVS	M6	25 mm	50 mm	38 mm

## Adjustable T-Arms

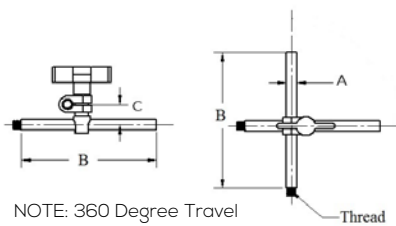

NOTE: 360 Degree Travel

Part Number	Thread	A	B	C
R20-AA	1/4-20	0.3125"	4"	0.6"
R8-AA	M8	8 mm	100 mm	15 mm
R6-AA	M6	8 mm	100 mm	15 mm

## Resting Pins

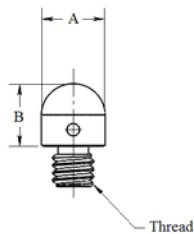

Part Number	Thread	A	B	Material
R20-SRP	1/4-20	0.375"	0.375"	Steel
R8-SRP	M8	13 mm	12 mm	Steel
R6-SRP	M6	9.5 mm	9.5 mm	Steel
R4-ARP	M4	6.3 mm	5 mm	Aluminum

## Cones

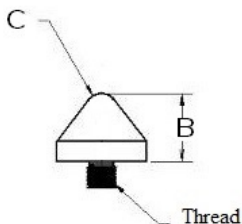
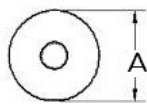

Part Number	Thread	A	B	C	Material
R20-NC	1/4-20	0.625"	0.50"	0.156"	Nylon
R20-SC	1/4-20	0.625"	0.50"	0.156"	Steel
R20-AC	1/4-20	1"	0.75"	0.1875"	Aluminum
R8-NC	M8	16 mm	13 mm	4 mm	Nylon
R8-NC-L	M8	25 mm	19 mm	4.8 mm	Nylon
R8-SC	M8	16 mm	13 mm	4 mm	Steel
R8-AC	M8	25 mm	19 mm	4.8 mm	Aluminum
R6-NC	M6	16 mm	13 mm	4 mm	Nylon
R6-NC-L	M6	25 mm	19 mm	4.8 mm	Nylon
R6-SC	M6	16 mm	13 mm	4 mm	Steel
R6-AC	M6	25 mm	19 mm	4.8 mm	Aluminum

Part Number	Thread	A	B	C	D
R20-75-TSB	1/4-20	0.75"	1.40"	2.240"	3.110"
R20-1-TSB	1/4-20	1"	1.40"	2.240"	3.235"
R8-19-TSB	M8	19 mm	35.6 mm	56.9 mm	79 mm
R8-25-TSB	M8	25 mm	35.6 mm	56.9 mm	82.2 mm
R6-19-TSB	M6	19 mm	35.6 mm	56.9 mm	79 mm
R6-25-TSB	M6	25 mm	35.6 mm	56.9 mm	82.2 mm

## Tension Spring Brackets

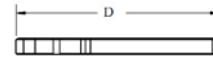
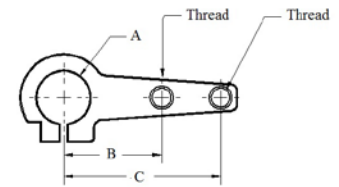

Part Number	Thread	A	B	C	D
R20-CTB-1	1/4-20	3.375"	1.273"	1"	1.19"
R8-CTB-25	M8	86 mm	32 mm	25 mm	30 mm
R6-CTB-25	M6	86 mm	32 mm	25 mm	30 mm

## Adjustable Tension Spring Bracket

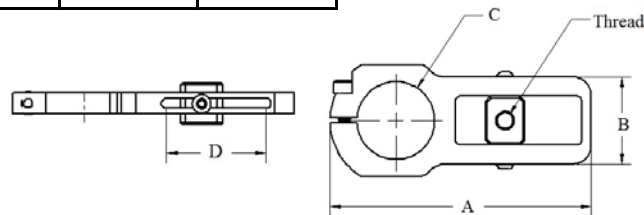

Part Number	Thread	A	B	C	D	Material
R20-SLD	1/4-20	3"	1"	1.545"	0.250"	Steel
R20-MSLD	1/4-20	1.375"	0.626"	0.563"	0.250"	Aluminum
R20-ASLD	1/4-20	2"	0.625"	1.25"	0.250"	Acrylic
R8-SLD	M8	65 mm	20 mm	32 mm	10 mm	Steel
R6-SLD	M6	75 mm	25 mm	40 mm	6.35 mm	Steel
R6-MSLD	M6	35 mm	16 mm	15 mm	6.35 mm	Aluminum
R6-ASLD	M6	50 mm	15.9 mm	31.8 mm	6 mm	Acrylic
R4-MSLD	M4	30 mm	12 mm	11 mm	5 mm	Aluminum
R4-ASLD	M4	38.1 mm	12.7 mm	20.6 mm	5 mm	Acrylic

## Slide Bases

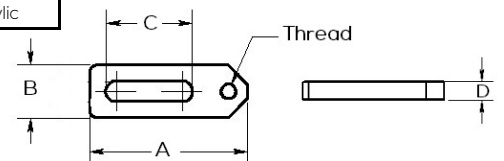

Part Number	Thread	A	B	C
R20-LB	1/4-20	0.75"	2.625"	1.25"
R20-LB-B (Base)	1/4-20	0.75"	2.625"	n/a
R8-LB	M8	25 mm	85 mm	40 mm
R8-LB-B (Base)	M8	25 mm	85 mm	n/a
R6-LB	M6	19 mm	66.7 mm	32 mm
R6-LB-B (Base)	M6	19 mm	66.7 mm	n/a
R4-LB	M4	16 mm	42 mm	24 mm
R4-LB-B (Base)	M4	16 mm	42 mm	n/a

## Locating Blocks

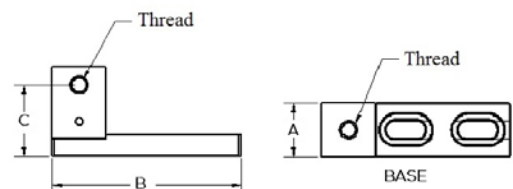

## Spring Holding Devices

Part Number	Thread	A	B	C	D
R20-SHD	1/4-20	0.5"	1"	1.75"	1.74"
R8-SHD	M8	13 mm	25 mm	44 mm	44 mm
R6-SHD	M6	13 mm	25 mm	44 mm	44 mm

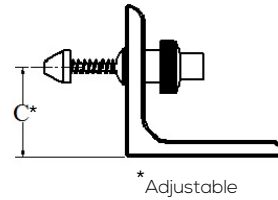
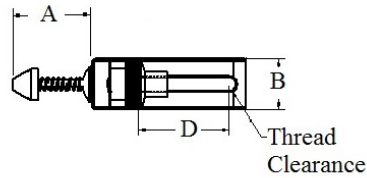

## Pusher Clamp

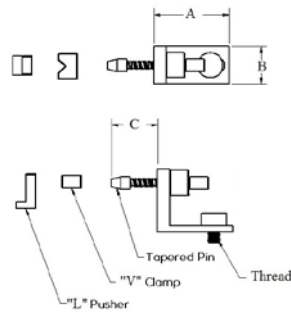

Part Number	Thread	A	B	C
R20-PC	1/4-20	1.5"	0.75"	0.15"
R6-PC	M6	38 mm	19 mm	3.8 mm
R4-PC	M4	38 mm	19 mm	3.8 mm

## Spring Loaded Pusher Clamp

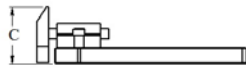
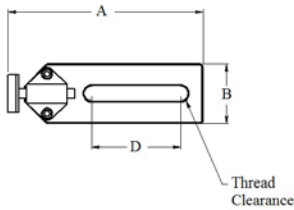

Part Number	Thread	A	B	C	D
R20-SLPC	1/4-20	3.25"	1"	0.90"	1.75"
R8-SLPC	M8	83 mm	25 mm	22.8 mm	44 mm
R6-SLPC	M6	83 mm	25 mm	22.8 mm	44 mm

## Adjustable Jackstands

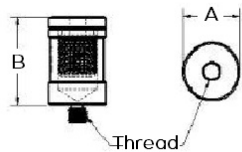

Part Number	Thread	A	B	Height Adjustment
R20-50-JS	1/4-20	0.625"	15"	0.500"
R20-1-JS	1/4-20	1"	15"	0.500"
R8-19-JS	M8	19 mm	38 mm	13 mm
R8-25-JS	M8	25 mm	38 mm	13 mm
R6-13-JS	M6	13 mm	38 mm	13 mm
R6-25-JS	M6	25 mm	38 mm	13 mm
R4-MJS	M4	9.5 mm	20.2 mm	5 mm

## Tooling Balls

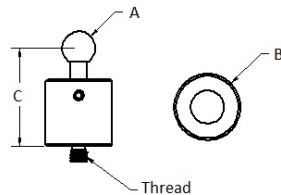

Part Number	Thread	A	B	C
R20-50-TB	1/4-20	0.5"	1"	1.5"
R8-12-TB	M8	12.7 mm	25 mm	38.1 mm
R6-12-TB	M6	12.7 mm	25 mm	38.1 mm

Part Number	Thread	A	B	C	D
R20-SDC	1/4-20	3.6"	0.15"	1"	0.6"
R20-LDC	1/4-20	5.030"	0.48"	15"	2.03"
R8-SDC	M8	25.4 mm	3.8 mm	25.4 mm	15.2 mm
R8-LDC	M8	127.8 mm	12.2 mm	38.1 mm	51.6 mm
R6-SDC	M6	91.4 mm	3.8 mm	25.4 mm	15.2 mm
R6-LDC	M6	127.8 mm	12.2 mm	38.1 mm	51.6 mm

## Hold Down Clamps

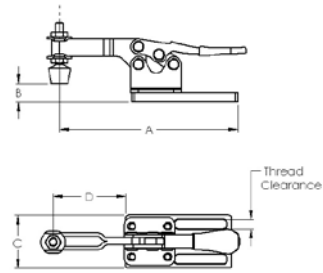

Part Number	Thread	A	B	C
R20-CJ3	1/4-20	5"	7"	3.75"
R8-CJ3	M8	127 mm	177.8 mm	95 mm
R6-CJ3	M6	127 mm	177.8 mm	95 mm

## 3 Jaw Chucks

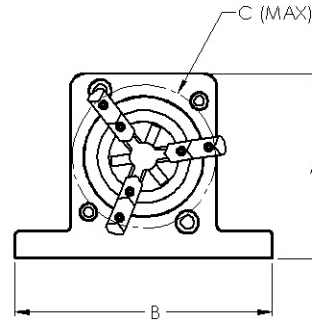
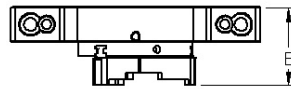

Part Number	Thread	A	B	C	D
R20-CJ3-R	1/4-20	4"	2.727"	15"	2.32"
R8-CJ3-R	M8	101.6 mm	69.27 mm	38.1 mm	59 mm
R6-CJ3-R	M6	101.6 mm	69.27 mm	38.1 mm	59 mm

## Rotational 3 Jaw Chucks

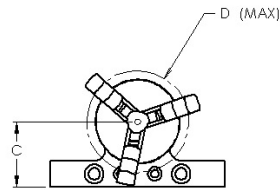
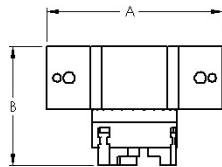

Part Number	Thread	A	B	C	Max Opening
R20-MV-2125	1/4-20	2.4"	4.40"	1.75"	2.2"
R8-MV-2125	M8	61 mm	111.75 mm	44 mm	55.90 mm
R6-MV-2125	M6	61 mm	111.75 mm	44 mm	55.90 mm

## Vices

\*Optional Rotational Base Available

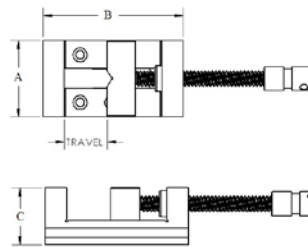

Part Number	A	B	C	Max Opening
R-MV-A	0.625"	1.69"	1.6"	0.84"
R-MV-B	0.625"	2"	1.78"	0.84"

Offered in 1/4-20, M6 and M4 thread

## Mini Vices

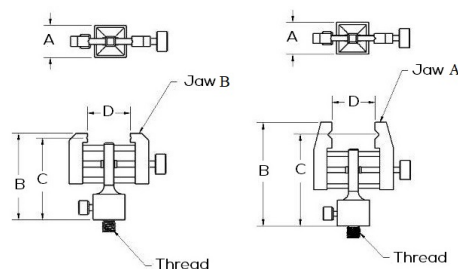

## Small Vice Clamp

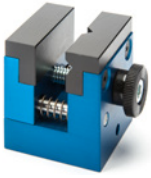

\*Standard SVC is supplied with plastic jaws as show

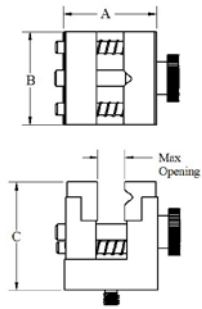

Part Number	Thread	A	B	C	Max Opening
R20-SVC	1/4-20	15"	15"	1.75"	0.45"
R8-SVC	M8	38 mm	38 mm	44.5 mm	11 mm
R6-SVC	M6	38 mm	38 mm	44.5 mm	11 mm
R4-SVC	M4	38 mm	38 mm	44.5 mm	11 mm

\*Jaw Material: Plastic, Aluminum and Steel

\*Jaw Design: Horizontal or Vertical V-notch

Stepped (to control seated depth of clamp part)

## 90 Degree Angle Brackets

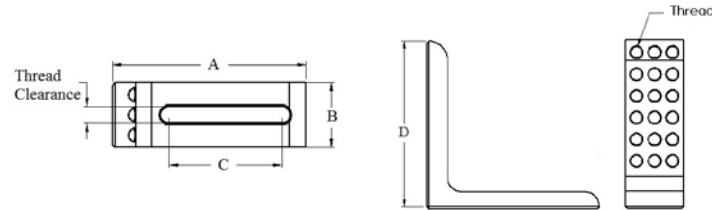

Part Number	Thread	A	B	C	D
R20-90L2 (2 rows)	1/4-20	3"	1"	1.75"	3"
R20-90L3 (3 rows)	1/4-20	3"	1"	1.75"	3"
R8-90L2 (2 rows)	M8	76 mm	25mm	44.45 mm	76.2 mm
R6-90L2 (2 rows)	M6	76 mm	25 mm	44.45 mm	76.2 mm
R6-90L3 (3 rows)	M6	76 mm	25 mm	44.45 mm	76.2 mm
R4-90L4 (4 rows)	M4	76 mm	25 mm	44.45 mm	76.2 mm

## Vertical Plates



Numbers in the X-Axis & Letters in the Z-Axis.

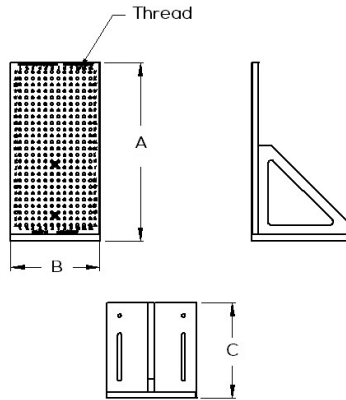

Part Number	Thread	A	B	C
R20-3250-50-VP	1/4-20	3"	2"	2"
R20-125-VP	1/4-20	12"	5"	6"
R20-147-VP	1/4-20	14"	7"	7.5"
R20-2010-VP	1/4-20	20"	10"	8"
R8-300125-VP	M8	300 mm	125 mm	127 mm
R8-350180-VP	M8	350 mm	180 mm	180 mm
R8-500250-VP	M8	500 mm	250 mm	203 mm
R8-755013-10-VP	M8	75 mm	50 mm	50 mm
R6-300125-VP	M6	300 mm	125 mm	127 mm
R6-350180-VP	M6	350 mm	180 mm	180 mm
R6-500250-VP	M6	500 mm	250 mm	203 mm
R6-755013-10-VP	M6	75 mm	50 mm	50 mm
R4-507513-10-VP	M4	50 mm	75 mm	38 mm

## Adjustable Angle Plate

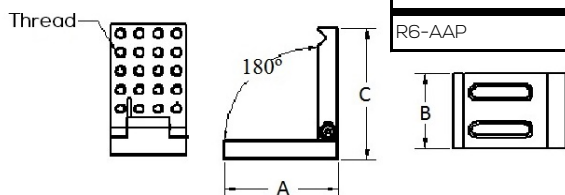

Part Number	Thread	A	B	C
R20-AAP	1/4-20	3"	2"	3.5"
R8-AAP	M8	75 mm	50 mm	88.9 mm
R6-AAP	M6	75 mm	50 mm	88.9 mm

Part Number	Thread	A	B	C
R20-16-MT4	1/4-20	6"	1" sq.	5"
R20-112-MT4	1/4-20	12"	1" sq.	5"
R20-1512-MT4	1/4-20	12"	1.5" sq.	6"
R20-1518-MT4	1/4-20	18"	1.5" sq.	6"
R20-224-MT4	1/4-20	24"	2" sq.	6"
R20-230-MT4	1/4-20	30"	2" sq.	6"
R8-25150-MT4	M8	150 mm	25 mm sq.	127 mm
R8-25300-MT4	M8	300 mm	25 mm sq.	127 mm
R8-38300-MT4	M8	300 mm	38 mm sq.	152.4 mm
R8-38450-MT4	M8	450 mm	38 mm sq.	152.4 mm
R8-50600-MT4	M8	600 mm	50 mm sq.	152.4 mm
R8-50750-MT4	M8	750 mm	50 mm sq.	152.4 mm
R6-25150-MT4	M6	150 mm	25 mm sq.	127 mm
R6-25300-MT4	M6	300 mm	25 mm sq.	127 mm

## Mini Towers

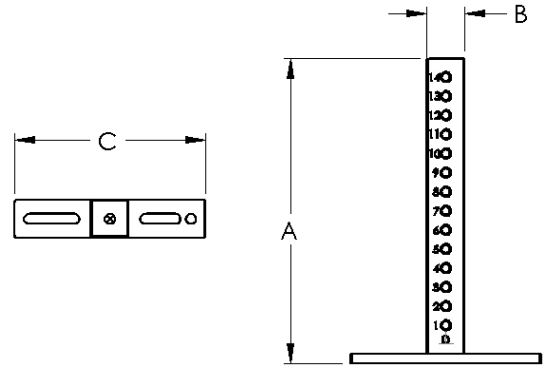

Part Number	Thread	A	B	C	D
R20-MCV	1/4-20	1.75"	0.5"	1.75"	0.25"
R20-CV	1/4-20	3.25"	0.75"	3.25"	0.25"
R8-MCV	M8	50 mm	19 mm	50 mm	9.5 mm
R8-CV	M8	82.5 mm	19 mm	82.5 mm	9.5 mm
R6-MCV	M6	44.43 mm	12.7 mm	44.43 mm	6.30 mm
R6-CV	M6	75.2 mm	19 mm	75.2 mm	6.30 mm
R4-MCV	M4	30 mm	10 mm	30 mm	5 mm
R4-CV	M4	50 mm	10 mm	50 mm	5 mm

## Corner Viewer

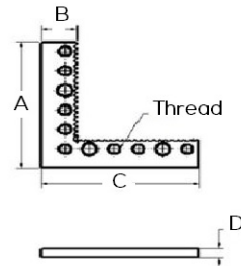

Part Number	Thread	A	B
R20-PJ	1/4-20	1125"	150"
R8-PJ	M8	28.60 mm	38.1 mm
R6-PJ	M6	28.60 mm	38.1 mm

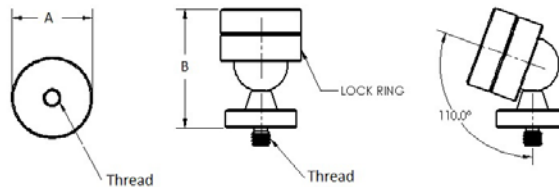

## Pivot Joints



Part Number	Thread	A	B
R20-APJ	1/4-20	0.75"	1.70"
R8-APJ	M8	19 mm	43.2 mm
R6-APJ	M6	19 mm	43.2 mm

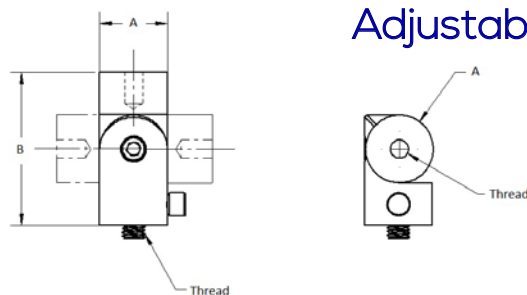

## Adjustable Pivot Joints



## Acrylic V-Blocks



Part Number	Thread	A	B	C	D
RA20-5-V	1/4-20	2"	1"	0.75" REF.	0.5"
RA6-13-V	M6	50 mm	25 mm	19 mm REF.	13 mm
RA4-6-V	M4	50 mm	25 mm	19 mm REF.	16 mm
RA4-13-V	M4	50 mm	25 mm	19 mm REF.	13 mm

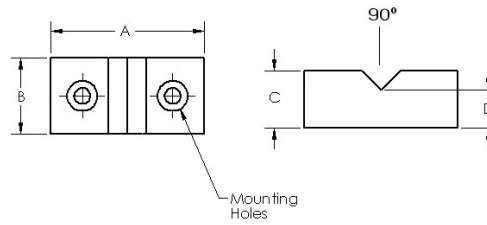

## Slide Base with Mirror

Part Number	Thread	A	B	C	D
R20-SLDM	1/4-20	3"	0.8"	1.375"	0.99"
R6-SLDM	M6	75 mm	20.3 mm	35 mm	25.2 mm
R4-SLDM	M4	75 mm	20.3 mm	35 mm	25.2 mm

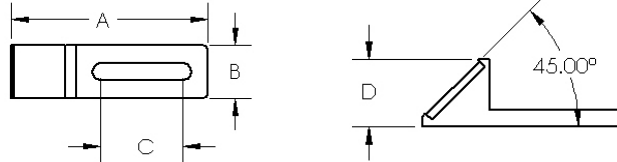

## Male Centers

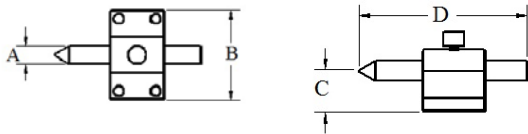

Part Number	Thread	A	B	C	D
R20-25-C	1/4-20	0.25"	2"	0.875"	2"
R20-50-C	1/4-20	0.5"	2.5"	1"	4"
R20-1-C	1/4-20	1"	2.5"	1"	4"
R8-6-C	M8	6.35 mm	50.8 mm	22.2 mm	50 mm
R8-13-C	M8	12.7 mm	63.5 mm	25.4 mm	101.6 mm
R8-25-C	M8	25.4 mm	63.5 mm	25.4 mm	101.6 mm
R6-6-C	M6	6.35 mm	50.8 mm	22.2 mm	50 mm
R6-13-C	M6	12.7 mm	63.5 mm	25.4 mm	101.6 mm
R6-25-C	M6	25.4 mm	63.5 mm	25.4 mm	101.6 mm

## Mini Male Center

Part Number	Thread	A	B	C	D
R4-MC	M4	32 mm	50 mm	8 mm	33 mm

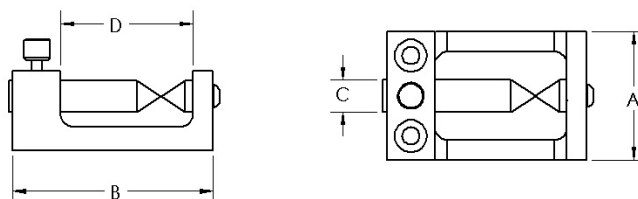

Part Number	Thread	A	B	C
R20-5-MS	1/4-20	5 mm	0.438"	1.378"
R20-10-SC	1/4-20	10 mm	0.63"	1.75"
R20-15-SC	1/4-20	15 mm	0.875"	1.75"
R20-20-SC	1/4-20	20 mm	1.125"	1.75"
R20-30-SC	1/4-20	30 mm	1.6"	2.5"
R20-50-SC	1/4-20	50 mm	2.5"	2.5"
R8-10-SC	M8	10 mm	16 mm	44.5 mm
R8-15-SC	M8	15 mm	22.2 mm	44.5 mm
R8-20-SC	M8	20 mm	28.6 mm	44.5 mm
R8-30-SC	M8	30 mm	41.7 mm	63.5 mm
R8-50-SC	M8	50 mm	64 mm	63.5 mm
R6-5-SC	M6	5 mm	11.3 mm	35 mm
R6-10-SC	M6	10 mm	16 mm	44.5 mm
R6-15-SC	M6	15 mm	22.2 mm	44.5 mm
R6-20-SC	M6	20 mm	28.6 mm	44.5 mm
R6-30-SC	M6	30 mm	41.7 mm	63.5 mm
R6-50-SC	M6	50 mm	64 mm	63.5 mm
R4-5-SC	M4	5 mm	11.3 mm	35 mm
R4-10-SC	M4	10 mm	16 mm	44.5 mm
R4-15-SC	M4	15 mm	22.2 mm	44.5 mm
R4-20-SC	M4	20 mm	28.6 mm	44.5 mm

## Suction Cups with Housing

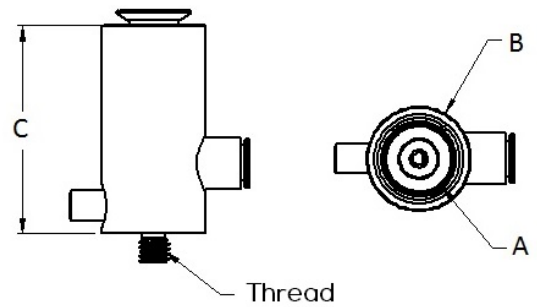

Part Number	Thread	A	B	C	Inc. Angle
R20-5-VSC	1/4-20	5 mm	0.438"	1.46"	90°
R20-10-VSC	1/4-20	10 mm	0.75"	1.875"	120°
R20-15-VSC	1/4-20	15 mm	1"	1.95"	120°
R20-20-VSC	1/4-20	20 mm	1.25"	2"	120°
R20-30-VSC	1/4-20	30 mm	1.75"	2.75"	120°
R20-50-VSC	1/4-20	50 mm	1.75"	3"	120°
R8-10-VSC	M8	10 mm	19 mm	50.8 mm	120°
R8-20-VSC	M8	20 mm	31.8 mm	50.8 mm	120°
R8-30-VSC	M8	30 mm	44.5 mm	75 mm	120°
R8-50-VSC	M8	50 mm	44.5 mm	75 mm	120°
R6-5-VSC	M6	5 mm	11.1 mm	37 mm	90°
R6-10-VSC	M6	10 mm	19 mm	37 mm	120°
R6-15-VSC	M6	15 mm	23.8 mm	50.8 mm	120°
R6-20-VSC	M6	20 mm	31.8 mm	50.8 mm	120°
R6-30-VSC	M6	30 mm	44.5 mm	75 mm	120°
R6-50-VSC	M6	50 mm	44.5 mm	75 mm	120°
R4-5-VSC	M4	5 mm	11.1 mm	37 mm	90°
R4-10-VSC	M4	10 mm	19 mm	50.8 mm	120°
R4-15-VSC	M4	15 mm	23.8 mm	50.8 mm	120°
R4-20-VSC	M4	20 mm	31.8 mm	50.8 mm	120°

## V-Suction Cups with Housing

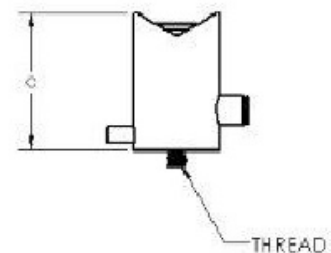
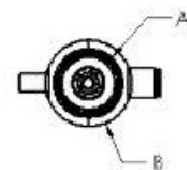

## Exposed Suction Cups

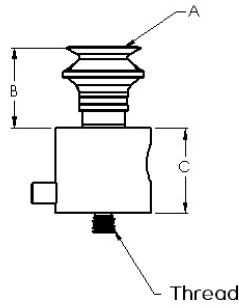

Part Number	Thread	A	B	C
R20-10-EXSC	1/4-20	10 mm	0.85"	1"
R20-20-EXSC	1/4-20	20 mm	0.96"	1"
R20-30-EXSC	1/4-20	30 mm	1.365"	1"
R20-50-EXSC	1/4-20	50 mm	1.72"	1"
R8-10-EXSC	M8	10 mm	21.6 mm	25.4 mm
R8-20-EXSC	M8	20 mm	24.4 mm	25.4 mm
R8-30-EXSC	M8	30 mm	34.7 mm	25.4 mm
R8-50-EXSC	M8	50 mm	43.7 mm	25.4 mm
R6-10-EXSC	M6	10 mm	21.6 mm	25.4 mm
R6-20-EXSC	M6	20 mm	24.4 mm	25.4 mm
R6-30-EXSC	M6	30 mm	34.7 mm	25.4 mm
R6-50-EXSC	M6	50 mm	43.7 mm	25.4 mm

## Slide Suction Cups

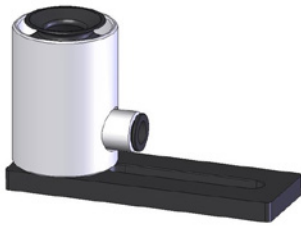

Part Number	Thread	A	B	C	D	E
R20-10-SSC	1/4-20	1"	10 mm	0.75"	2"	3"
R20-15-SSC	1/4-20	1"	15 mm	0.875"	2"	3"
R20-20-SSC	1/4-20	1"	20 mm	1.125"	2"	3"
R8-10-SSC	M8	25.4 mm	10 mm	19 mm	50 mm	76.2 mm
R8-15-SSC	M8	25.4 mm	15 mm	22.2 mm	50 mm	76.2 mm
R8-20-SSC	M8	25.4 mm	20 mm	28.6 mm	50 mm	76.2 mm
R6-10-SSC	M6	25.4 mm	10 mm	19 mm	50 mm	76.2 mm
R6-15-SSC	M6	25.4 mm	15 mm	22.2 mm	50 mm	76.2 mm
R6-20-SSC	M6	25.4 mm	20 mm	28.6 mm	50 mm	76.2 mm

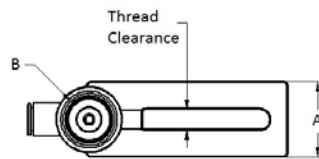
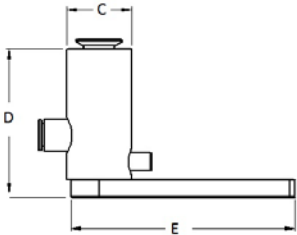

## Square V-Suction Cups



Part Number	Thread	A	B	C	D	Inc. Angle
R20-20-SVSC	1/4-20	5"	1.875"	20 mm	3"	120°
R20-50-SVSC	1/4-20	6"	3.5"	50 mm	3"	150°
R8-20-SVSC	M8	127 mm	48.2 mm	20 mm	76.2 mm	120°
R8-50-SVSC	M8	152.4 mm	88.9 mm	50 mm	76.2 mm	150°
R6-20-SVSC	M6	127 mm	48.2 mm	20 mm	76.2 mm	120°
R6-50-SVSC	M6	152.4 mm	88.9 mm	50 mm	76.2 mm	150°

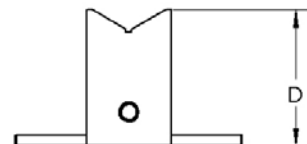
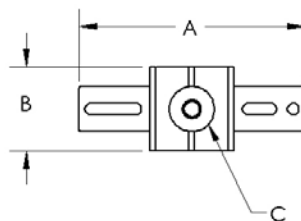

Part Number	Description
R-X10L	X10L Vacuum Pump, 1/8" Male Quick Disconnect
R-9P-M	9 Port Manifold
R-13P-M	13 Port Manifold
R-12-VH	Vacuum Hose, 12" Long
R-18-VH	Vacuum Hose, 18" Long
R-24-VH	Vacuum Hose, 24" Long
R-36-VH	Vacuum Hose, 36" Long
R-60-VH	Vacuum Hose, 60" Long
R-120-VH	Vacuum Hose, 120" Long
R-PMC1002	Open Coupler
R-PMCD1002	Closed Coupler
R-PMCD2202	Straight Hose Barb
R-PMC2302	Elbow Hose Barb

## Vacuum Accessories

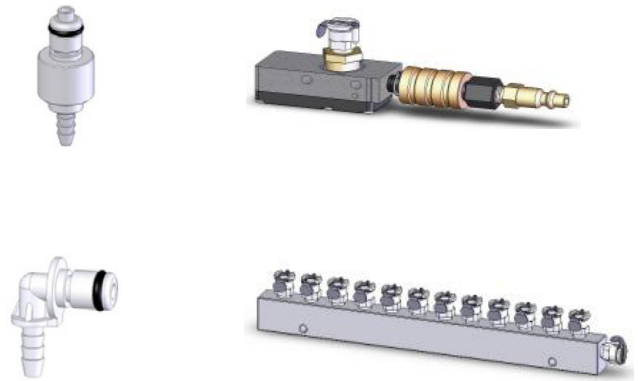

Part Number	Description
R20-DK-45	1/4-20 x 5/8 SHCS with Thumb Screw Cap
R20-HDS-L	1/4-20 Threaded Hold Down Screw Large
R20-HDS-S	1/4-20 Threaded Hold Down Screw Small
R20-AS	1/4-20 Adapter Screw
R8-AS	M8 Threaded Adapter Screw
R8-HDS-L	M8 Threaded Hold Down Screw
R6-DK-45	M6 x 16 mm SHCS with Thumb Screw Cap
R6-HDS-L	M6 Threaded Hold Down Screw Large
R6-AS	M6 Threaded Adapter Screw
R4-AS	M4 Threaded Adapter Screw

## Screws & Mounting Pins



Part Number	Description
R20-SCT	Small Component Tray for 1/4-20 Thread
R20-LCT	Large Component Tray for 1/4-20 Thread
R8-SCT	Small Component Tray for M8 Thread
R8-LCT	Large Component Tray for M8 Thread
R6-SCT	Small Component Tray for M6 Thread
R6-LCT	Large Component Tray for M6 Thread
R4-MCT	Mini Component Tray for M4 Thread
AX-BOX	Organizer Box
R-CASE-B	Case for Clamping Kit B (1 Layer)
R-CASE-C	Case for Clamping Kit C (2 Layer)
R-VCT	Vacuum Component Tray

## Component Trays & Cases



# AX Kits: Aluminum Extrusions



AX-KIT-3

Part Numbers	Description	AX-KIT-1	AX-KIT-2	AX-KIT-3
AX-16	1" x 1" x 6" Arm	2	2	4
AX-112	1" x 1" x 12" Arm			2
AX-1212	1" x 2" x 12" Arm	1	2	
AX-126	1" x 2" x 6" Arm			2
AX1-2-12	1" x 2" x 12" Arm			4
AX-218	2" x 2" x 18" Arm	1	1	3
AX-224	2" x 2" x 24" Arm	2	2	4
AX-230:	2" x 2" x 30" Arm			2
AX-236	2" x 2" x 36" Arm		2	4
AX-242	2" x 2" x 42" Arm			2
AX20-2AF	2" W. Angle Foot To Base Plate with 1/4-20 Thread	4	6	16
AX-2AB4	2" W. Angle Bracket with 4 Holes	2	2	8
AX-2AG8	2" Angle with 8 Holes	2	2	6
AX-1AG4	1" Wide Angle Gusset with 4 Holes	2	2	4
AX-2AG8	2" Wide Angle Gusset with 8 Holes	2	2	12
AX-21AT6	2" Wide Angle Transition with 6 Holes	1	2	6
AX-JP8	2" Wide Joining Plate with 8 Holes			4
AX-12AB	12" Angle Brace		2	4
AX-15AB	15" Angle Brace			2
AX20-33	3" x 3" x 1/2" Grid Plate, 1/4-20 Threaded Holes	2	4	8
AX20-36	3" x 6" x 1/2" Grid Plate, /4-20 Threaded Holes	1	3	6
AX-1-C	1" sq. End Cap	2	2	4
AX-12-C	1" x 2" End Cap	1	2	6
AX-2-C	2" sq. End Cap	4	6	16
AX-NUT	T-Nut	86	100	320
AX-PVNUT	Pivot T-Nut	8	12	32
AX-BOX	Organizer Box	1	1	1
<b>Total Components</b>		<b>39</b>	<b>155</b>	<b>482</b>

# Extrusion Accessories

Part Number	Description
AX-16	1" sq x 6" Arm
AX-112	1" sq. x 12" Arm
AX-126	1" x 2" x 6" Arm
AX-1212	1" x 2" x 12" Arm
AX-1218	1" x 2" x 18" Arm
AX-1224	1" x 2" x 24" Arm
AX-26	2" sq. x 6" Arm
AX-218	2" sq. x 18" Arm
AX-224	2" sq. x 24" Arm
AX-230	2" sq. x 30" Arm
AX-236	2" sq. x 36" Arm
AX-242	2" sq. x 42" Arm
AX-248	2" sq. x 48" Arm
AX-260	2" sq. x 60" Arm
AX-324	3" sq. x 24" Arm
AX-336	3" sq. x 36" Arm
AX-348	3" sq. x 48" Arm
AX-360	3" sq. x 60" Arm

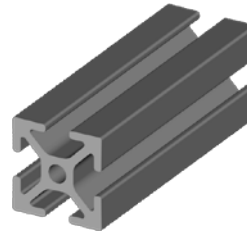
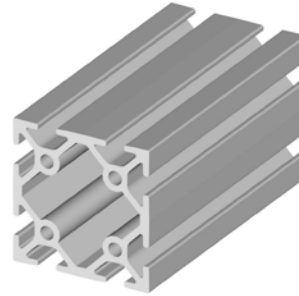

Arms

Part Number	Description
AX-NUT	T-Nut
AX-3NUT	T-Nut
AX-PVNUT	Pivot T-Nut

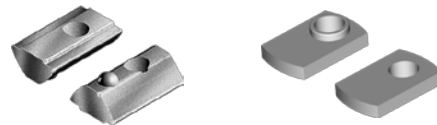

T-Nuts

Part Number	Description
AX20-2AF	2" Wide Angle Foot to Base Plate (1/4-20 Threads)
AX8-2AF	2" Wide Angel Foot to Base Plate (M8 Threads)



Angle Foot

Part Number	Description
AX-JP6	Joining Plate with 6 Holes
AX-JP8	Joining Plate with 8 Holes
AX-JP12	Joining Plate with 12 Holes

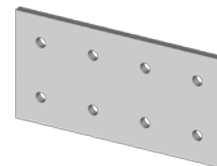

Joining Plate

Part Number	Description
AX-1AB4	1" Wide Angle Bracket with 4 holes
AX-2AB4	2" Wide Angle Bracket with 4 holes
AX-2AB6	2" Wide Angle Bracket with 6 Holes
AX-2AB8	2" Wide Angle Bracket with 8 Holes
AX-2AB8	2" Wide Angle Bracket with 8 Holes



Angle Bracket

## Angle Brace



Part Number	Description
AX-12AB	12" Angle Brace
AX-15AB	15" Angle Brace
AX-18AB	18" Angle Brace

## Angle Gusset



Part Number	Description
AX-1AG4	1" Wide Angle Gusset with 4 holes
AX-2AG4	2" Wide Angle Gusset with 4Holes
AX-2AG8	2" Wide Angle Gusset with 8 Holes
AX-3AG4	3" Wide Angle Gusset with 4 Holes
AX-3AG8	3" Wide Angle Gusset with 8 Holes

## Angle Transition

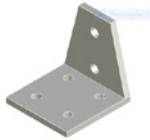

Part Number	Description
AX-21A6	2" Angle Transition with 6 Holes
AX-23A8	2" Angle Transition with 8 Holes

## Grid Plate



Part Number	Description
AX20-33	3" x 3" x 1/2" Aluminum Plate with 1/4-20 Threaded Holes
AX20-36	3" x 6" x 1/2" Aluminum Plate with 1/4-20 Threaded Holes
AX8-9090	90mm x 900mm x 13mm Aluminum Plate with M8 Threaded Holes
AX8-90165	90mm x 165mm x 13mm Aluminum Plate with M8 Threaded Holes

## End Caps

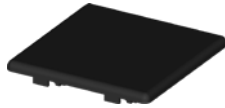

Part Number	Description
AX-1-C	1" x 1" End Cap
AX-12-C	1" x 2" End Cap
AX-2-C	2" x 2" End Cap
AX-3-C	3" x 3" End Cap

## Rotating Base

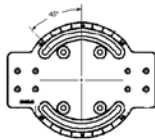

Part Number	Description
AX20-RB	5" x 5" Rotational Base

## Top Plate

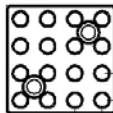

Part Number	Description
AX20-TP	2" x 2" x 1/2" Top Plate

## Case



Part Number	Description
AX-BOX	Organizer Box

## Screws

Part Number	Description
AX20-BH-50	1/4-20 Button Head Cap Screw
AX20-BH-63	1/4-20 Button Head Cap Screw
AX8-BH	M8 Button Head Cap Screw
AX20-SH-50	1/4-20 Socket Head Cap Screw
AX20-SH-63	1/4-20 Socket Head Cap Screw
AX8-SH	M8 Socket Head Cap Screw



# PLATE DIMENSIONS AND MOUNTING HOLE LOCATIONS

MACHINE: \_\_\_\_\_

PLATE MATERIAL: \_\_\_\_\_

FINISH: \_\_\_\_\_

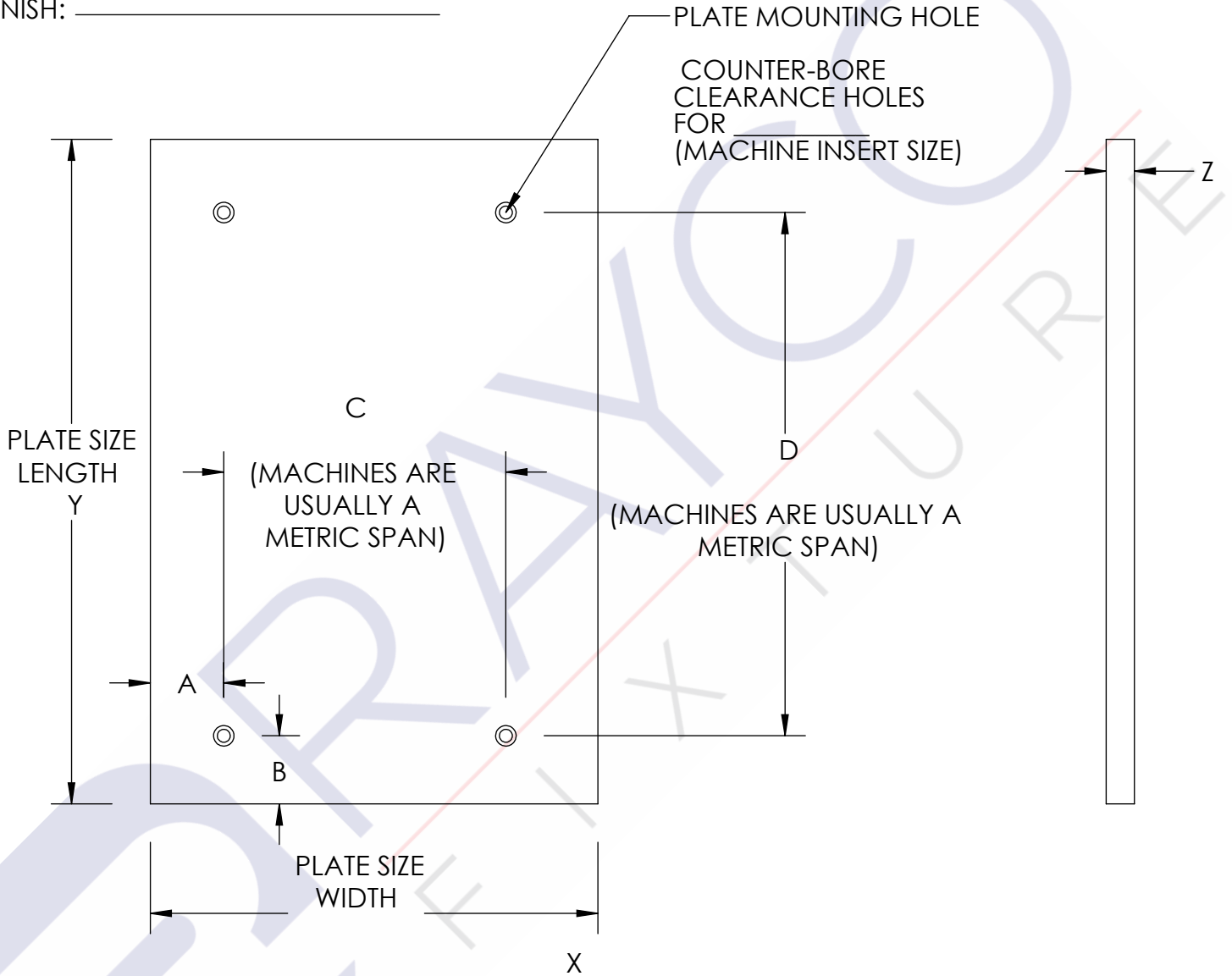

X: \_\_\_\_\_ PLATE WIDTH

Y: \_\_\_\_\_ PLATE LENGTH

Z: \_\_\_\_\_ PLATE THICKNESS

A: \_\_\_\_\_ DISTANCE FROM PLATE LEFT EDGE TO 1ST MOUNTING HOLE

B: \_\_\_\_\_ DISTANCE FROM PLATE BOTTOM EDGE TO 1ST MOUNTING HOLE

C: \_\_\_\_\_ SPAN OF BETWEEN MOUNTING HOLES IN PLATE X

D: \_\_\_\_\_ SPAN BETWEEN MOUNTING HOLES IN PLATE Y



Rayco Fixture, Inc.  
5520 Bridgewood Dr.  
Sterling Heights MI 48310

Office: (586)795-2884  
Fax: (586) 795-3260  
Email: sales@raycofixture.com



# Borbolla

METROLOGY

ventas@borbollametrology.com  
www.borbollametrology.com  
Tel 844 4128868

